



Conquest Tower, SE1

£700 Per week

Two bedroom, two bathroom apartment on the 10th floor of this new development. The property has features a high quality finish, great views, underfloor heating, ventilation system, floor to ceiling windows and winter garden.

The famous Southbank is a short walk away with festivals, cinemas and pop-up markets to enjoy. A walk across the river is London's bustling West End, home to countless shops, restaurants, and theatres.

Features

- Two Bedroom
- Two Bathroom
- 10th Floor
- Winter Garden
- Panoramic City Views
- Brand New Development

Blackfriars Road, London, SE1

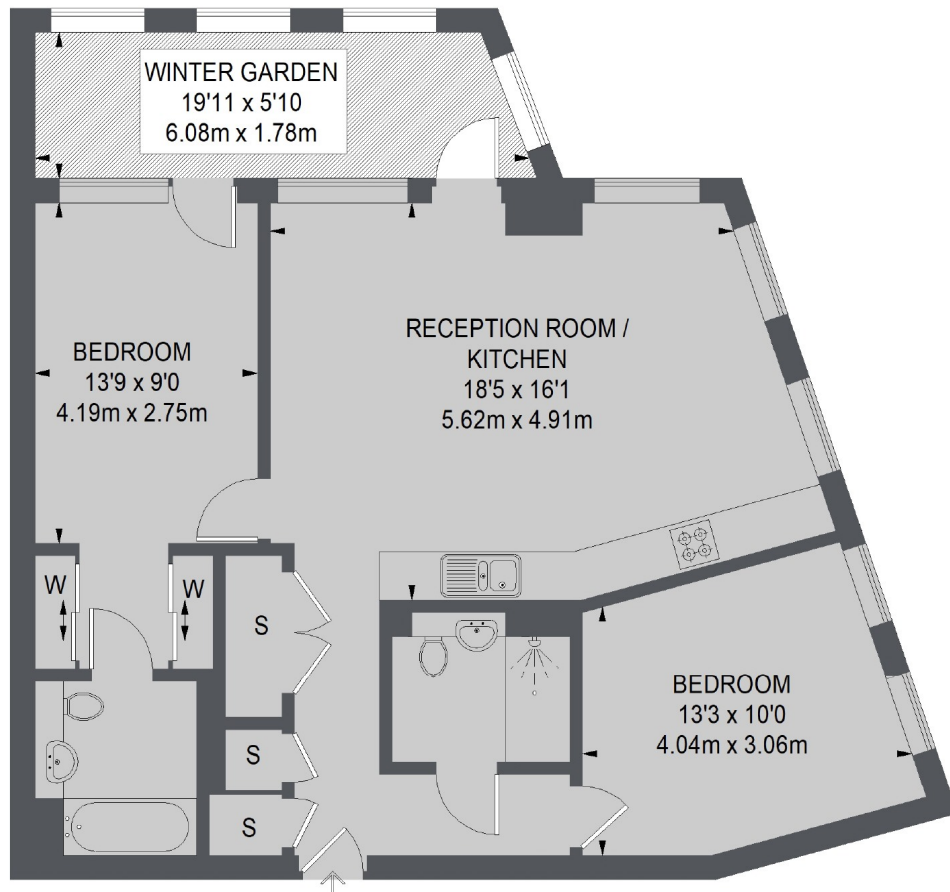

**TOTAL APPROX. FLOOR AREA
(EXCLUDING WINTER GARDEN)
849 SQ. FT. (78.9 SQ. M.)**

Contact

To arrange a viewing call our office on the number below or visit our website.



Energy Rating: B. We aim to make our particulars both accurate and reliable. However they are not guaranteed; nor do they form part of an offer or contract. If you require clarification on any points then please contact us, especially if you're traveling some distance to view. Please note that appliances and heating systems have not been tested and therefore no warranties can be given as to their good working order.