



## Southwark Bridge Road, SE1

### £740,000

This beautifully refurbished and extended garden flat boasts two generously sized double bedrooms, two bathrooms with both walk-in shower and bath, bespoke fitted storage, upgraded sash windows, a spacious and modern fitted kitchen and open-plan living area, and a large private west-facing garden.

Situated in the heart of SE1, this property enjoys an enviable location between Borough, Southwark, and London Bridge stations, offering excellent transport links. Iconic attractions such as Bankside, Borough Market, the Tate Modern, and the Globe Theatre are all just moments away, while Westminster, Waterloo, and the City are easily accessible.

### Features

£740,000  
 Victorian Conversion  
 Excellent Condition  
 Modern Fitted Kitchen and  
 Bath Rooms  
 Open Plan Living  
 Private Garden

# Southwark Bridge Road, London, SE1

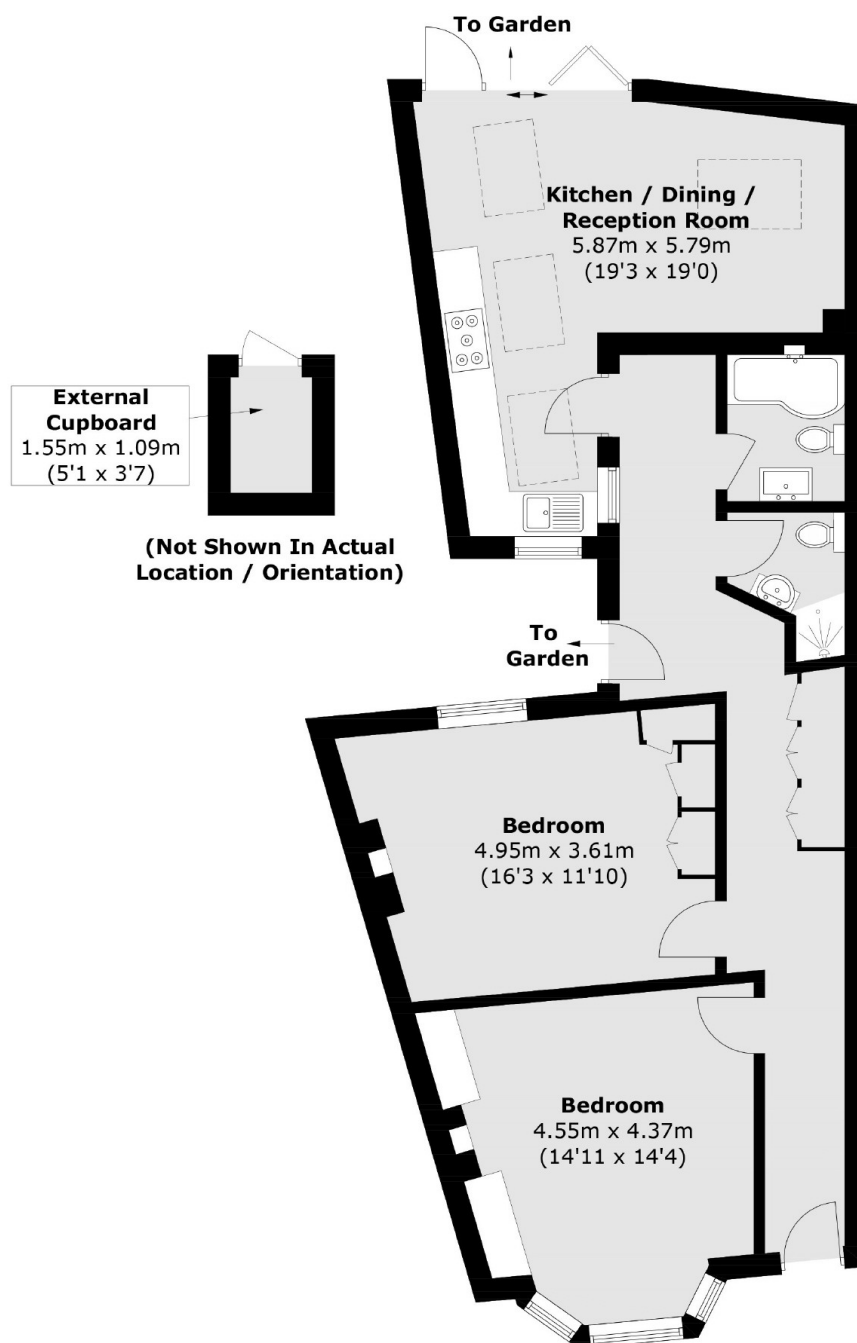

Total area (approx.): 82.5 sq. m (888.0 sq. ft)  
External Cupboard area (approx.): 1.8 sq. m (19.4 sq. ft)