



## Sanctuary Street, SE1

£650,000

A highly attractive modern apartment, with a generous open plan living room and modern kitchen, leading out onto a private balcony, two double bedrooms and two bathrooms, ample storage and sold with secure, allocated, underground parking.

Sanctuary Street is ideally located, just behind Borough Station, tucked back off Marshalsea Road, at the foot of Borough High Street. London Bridge, Borough Market and the South Bank are all close by, with excellent transport links across the city.

### Features

- Two Bedrooms & Two Bathrooms
- Private Balcony
- Lift Access & Secure Entry
- Secure Underground Parking
- Excellent Transport Links

# Sanctuary Street, London, SE1

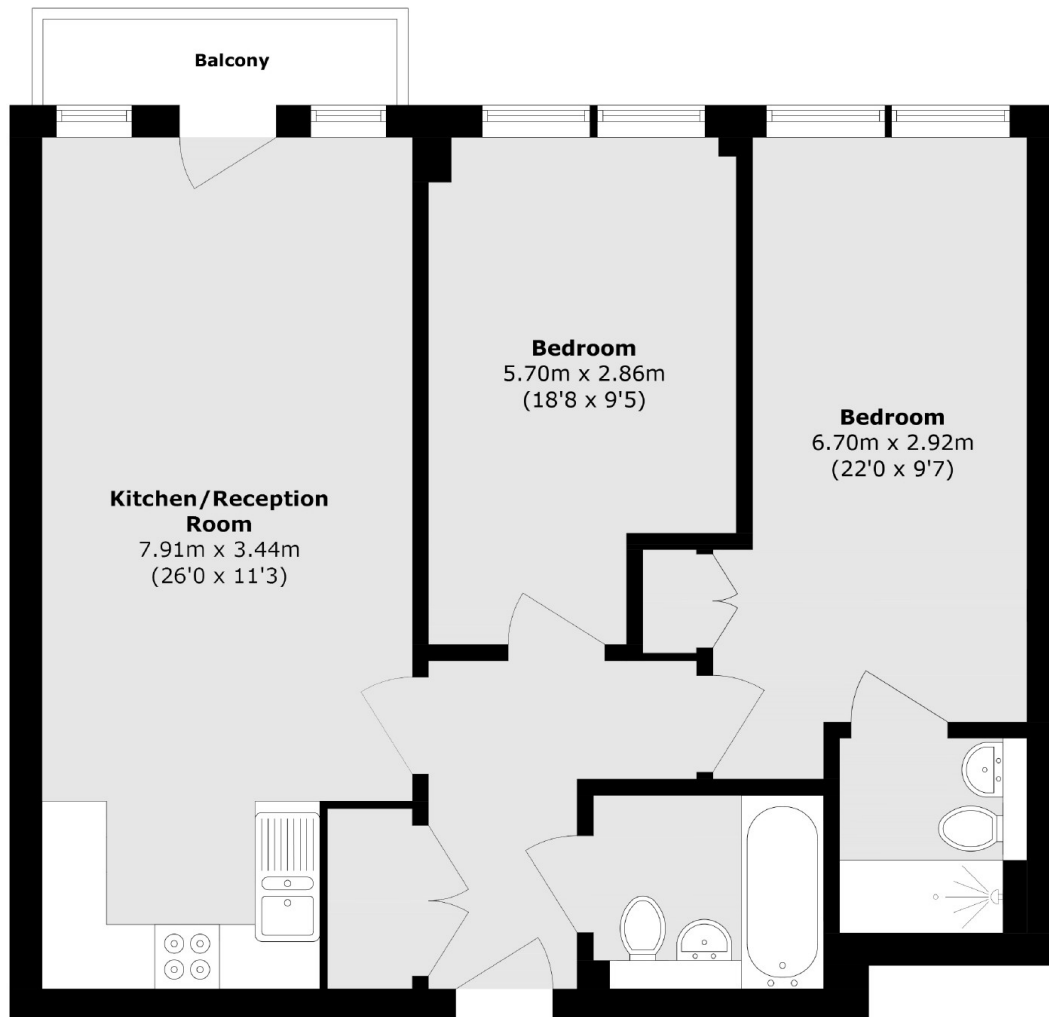

Total area (approx.): 71.4 sq. m (768.5 sq. ft)

Balcony area (approx.): 2.6 sq. m (27.9 sq. ft)

## Dexters

London Bridge  
54 Borough High Street  
London  
SE1 1XL  
Sales  
020 7650 5 100

Energy Rating: . We aim to make our particulars both accurate and reliable. However they are not guaranteed; nor do they form part of an offer or contract. If you require clarification on any points then please contact us, especially if you're traveling some distance to view. Please note that appliances and heating systems have not been tested and therefore no warranties can be given as to their good working order.

 **RICS** | Regulated  
Estate Agent  
and Letting Agent

[dexters.co.uk](http://dexters.co.uk)