



Southwark Bridge Road, SE1

£715,000

This beautifully refurbished and extended garden flat features two spacious double bedrooms, two stylish bathrooms - one with a walk-in shower and the other with a bath - bespoke fitted storage, upgraded sash windows, and a modern open-plan kitchen and living area. At the rear, a large private west-facing garden offers the perfect space for relaxing or entertaining.

Situated in the vibrant heart of SE1, this property is perfectly positioned between Borough, Southwark, and London Bridge stations, providing superb transport connections. A wealth of cultural and culinary landmarks are on the doorstep, including Bankside, Borough Market, the Tate Modern, and the Globe Theatre, while Westminster, Waterloo, and the City are all within easy reach.

Features

- Victorian Conversion
- Excellent Condition
- Modern Fitted Kitchen and Bath Rooms
- Open Plan Living
- Private Garden

Southwark Bridge Road, London, SE1

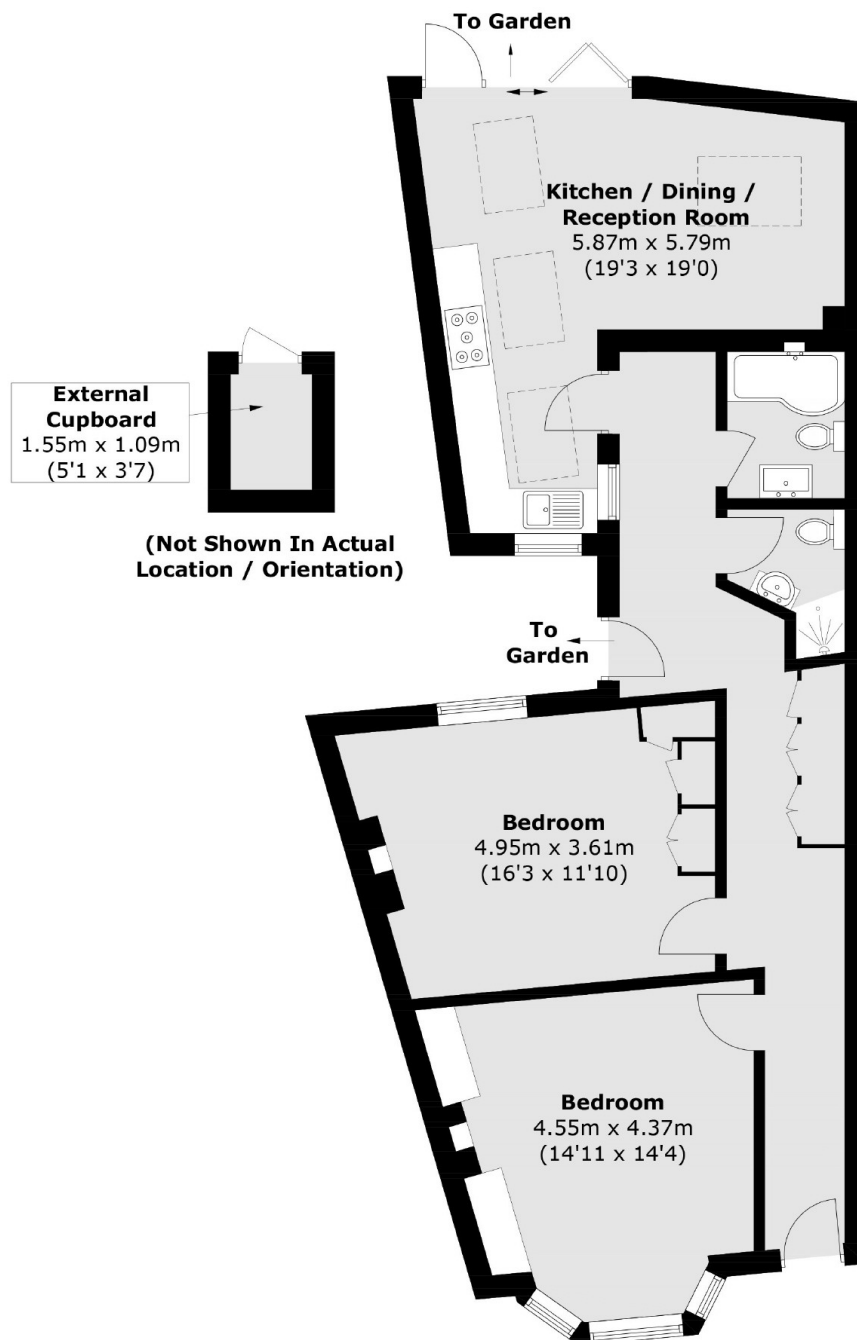

Total area (approx.): 82.5 sq. m (888.0 sq. ft)
External Cupboard area (approx.): 1.8 sq. m (19.4 sq. ft)

Dexters

London Bridge
54 Borough High Street
London
SE1 1XL
Sales
020 7650 5 100

Energy Rating: C. We aim to make our particulars both accurate and reliable. However they are not guaranteed; nor do they form part of an offer or contract. If you require clarification on any points then please contact us, especially if you're traveling some distance to view. Please note that appliances and heating systems have not been tested and therefore no warranties can be given as to their good working order.

 **RICS** | Regulated
Estate Agent
and Letting Agent

[dexters.co.uk](https://www.dexters.co.uk)