

St. Georges Circus, SE1

£650,000

A very high spec modern apartment with views of the Shard, an open plan living room & kitchen, winter garden, generous double bedroom, smart three piece bathroom & ample storage. 24hr concierge, residents' lounge, terrace & gym. OIEO £650,000.

Blackfriars Circus is one of SE1's premier modern developments, on Blackfriars Road, with easy access to Southwark, Waterloo, Waterloo East and the Southbank. Blackfriars Station and the City are just a hop over the bridge.

Features

- High Spec Apartment
- Winter Garden
- 24 Hour Concierge
- Residents' Gym
- Residents' Lounge
- EWS1 Form in Place
- Offers in excess of £650,000

St. Georges Circus, London, SE1

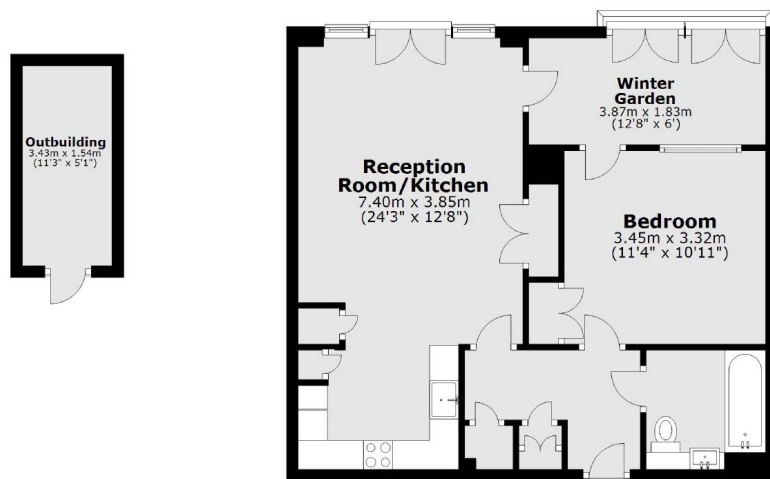

Main area: Approx. 59.3 sq. metres (638.0 sq. feet)
Plus outbuildings, approx. 5.3 sq. metres (56.9 sq. feet)

Dexters

London Bridge
54 Borough High Street
London
SE1 1XL
Sales
020 7650 5 100

Energy Rating: C. We aim to make our particulars both accurate and reliable. However they are not guaranteed; nor do they form part of an offer or contract. If you require clarification on any points then please contact us, especially if you're traveling some distance to view. Please note that appliances and heating systems have not been tested and therefore no warranties can be given as to their good working order.

 **RICS** | Regulated
Estate Agent
and Letting Agent

[dexters.co.uk](https://www.dexters.co.uk)