



Casson Square, SE1

£1,442 Per week

Stunning, North-Facing, 2 bedroom apartment in the sought after 8 Casson Square development on the South Bank. The apartment has 2 double bedrooms, 2 bathrooms and an open plan Living room and kitchen. The apartment has a 24hr concierge and residents gym, spa and swimming pool.

Close to Waterloo Station, Southwark tube and the many eclectic shops, bars, restaurants and theatres along The Cut together with many leisure facilities that the South Bank offers including, the Tate Modern, Royal Festival Hall and Borough Market towards London Bridge.

Features

Two Bedroom
Luxury Apartment
25th Floor
Large Balcony
River Views
Luxury Amenities



Casson Square, SE1

Stunning, North-Facing, 2 bedroom apartment with River-Views in the sought after 8 Casson Square development on the South Bank. The apartment has 2 double bedrooms, 2 bathrooms and an open plan Living room and kitchen. The apartment has a 24hr concierge and residents gym, spa and swimming pool.



Casson Square, London, SE1

Casson Square SE1
4Gross Internal Area:
80 Sq. metres
865 Sq.feet



25th Floor

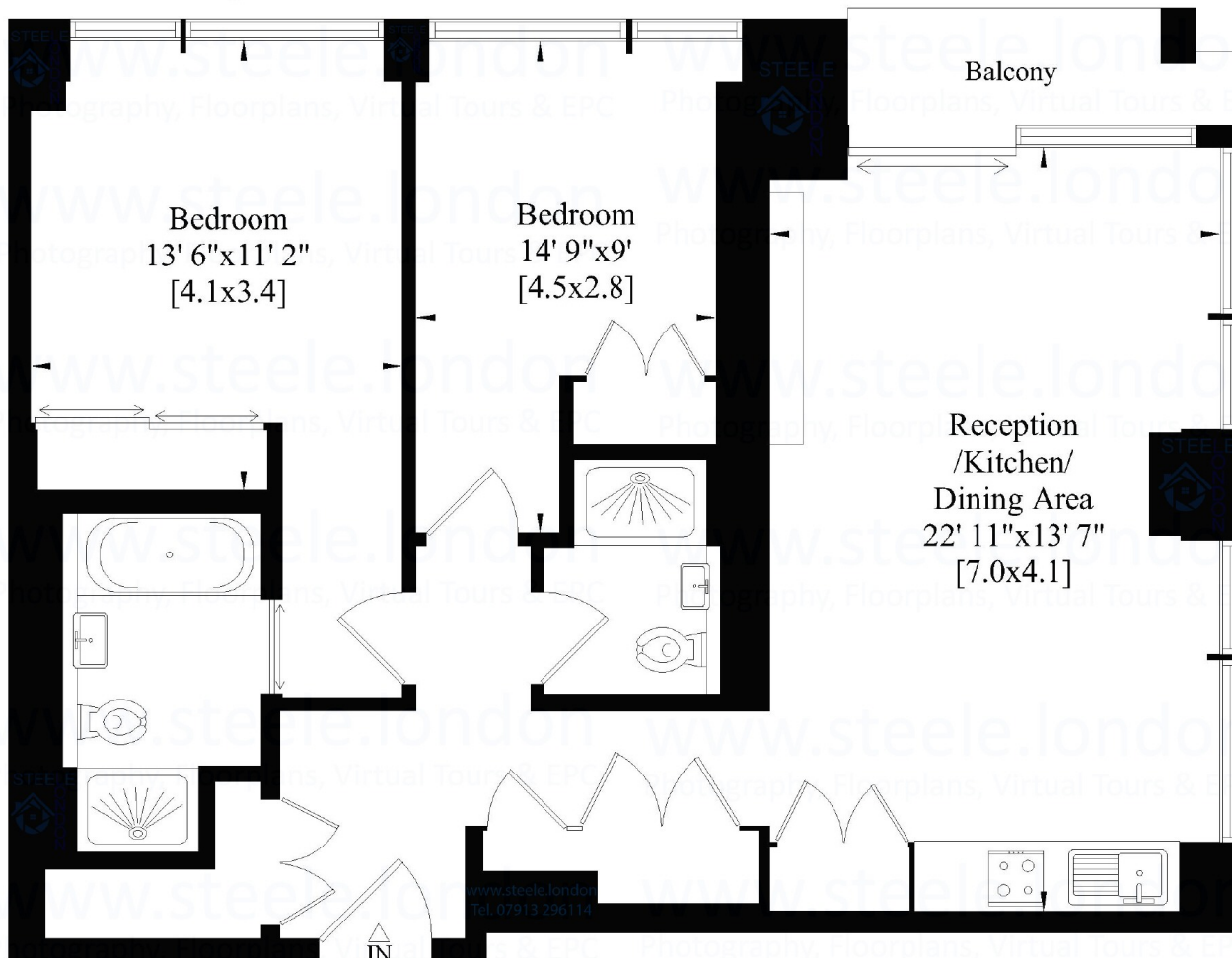

Prepared for Dexters Estate Agents www.dexters.co.uk/property-lettings To Let 2 Bedroom Flat Casson Square Waterloo SE1
Whilst every attempt has been made to ensure the accuracy of this Lettings floor plan measurements of doors, windows, rooms & Sq.footage are approximate. For Identification Purposes only. The actual property will vary. Price on application for a 90 day Licence to use this lettings plan ©05082025. Not to scale.

Photography, Drone, Floor Plan, Virtual Tours, Virtual Staging, Video & EPC's by
www.steele.london email. patricia@steele.london Tel. 07847219401 or Tel. 07913 296114



Dexters

London Bridge
54 Borough High Street
London
SE1 1XL
Lettings
020 7650 5101

Energy Rating: B. We aim to make our particulars both accurate and reliable. However they are not guaranteed; nor do they form part of an offer or contract. If you require clarification on any points then please contact us, especially if you're traveling some distance to view. Please note that appliances and heating systems have not been tested and therefore no warranties can be given as to their good working order.



Regulated
Estate Agent
and Letting Agent

dexters.co.uk