



## Weston Street, SE1

£375,000

A highly attractive top floor, Victorian conversion featuring original beams and charming character throughout. The property benefits from high ceilings and elegant sash windows, creating a bright and airy feel. The accommodation includes a spacious living room that flows through to a generous kitchen-diner, a large double bedroom, and a modern en-suite shower room.

Perfectly positioned on Weston Street in the heart of SE1, Bridgewalk Heights is just 100 yards from London Bridge Station. Bermondsey Street's celebrated food scene, galleries & cafés are moments away, while the South Bank offers iconic riverside walks past Borough Market, Tate Modern & numerous cultural landmarks.

### Features

- Top Floor Flat
- Victorian Conversion
- Original Beams & Sash Windows
- Large Living Room
- Separate Kitchen-Diner
- Chain Free Sale



**Weston Street, SE1**



# Weston Street, London, SE1

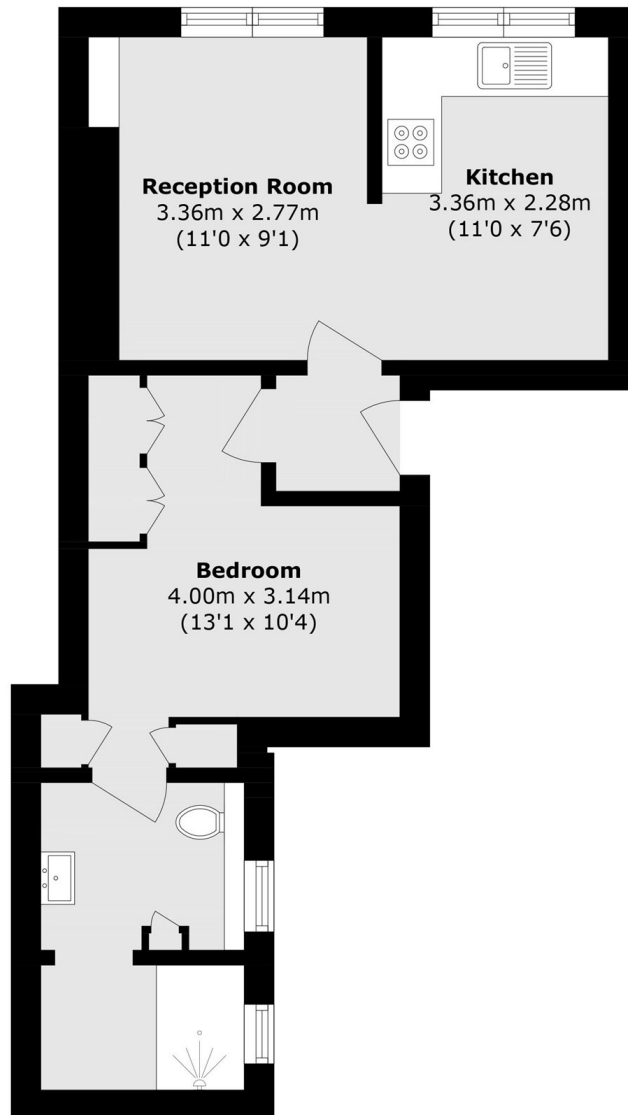

## Fourth floor

Total area (approx.): 46.2 sq. m (497.2 sq. ft)