

## Malthouse Road, SW11

£658 Per week

A well-presented one bedroom apartment within this luxurious Nine Elms development presents a spacious open plan reception room, a high specification kitchen, wooden flooring throughout, a modern bathroom and a private balcony. The property further benefits from a resident's gym, communal roof terrace and media lounge.

Lexington Gardens is perfectly located, providing close transport links including Nine Elms, Battersea Power Station & Vauxhall underground station. The property is also moments away from the amenities of Embassy Gardens and Battersea Power Station; shops, restaurants and cafés.

### Features

- One Double Bedroom
- Modern Bathroom
- High Specification
- Residents Gym
- 24/7 Concierge
- Prime Location

# Malthouse Road, London, SW11

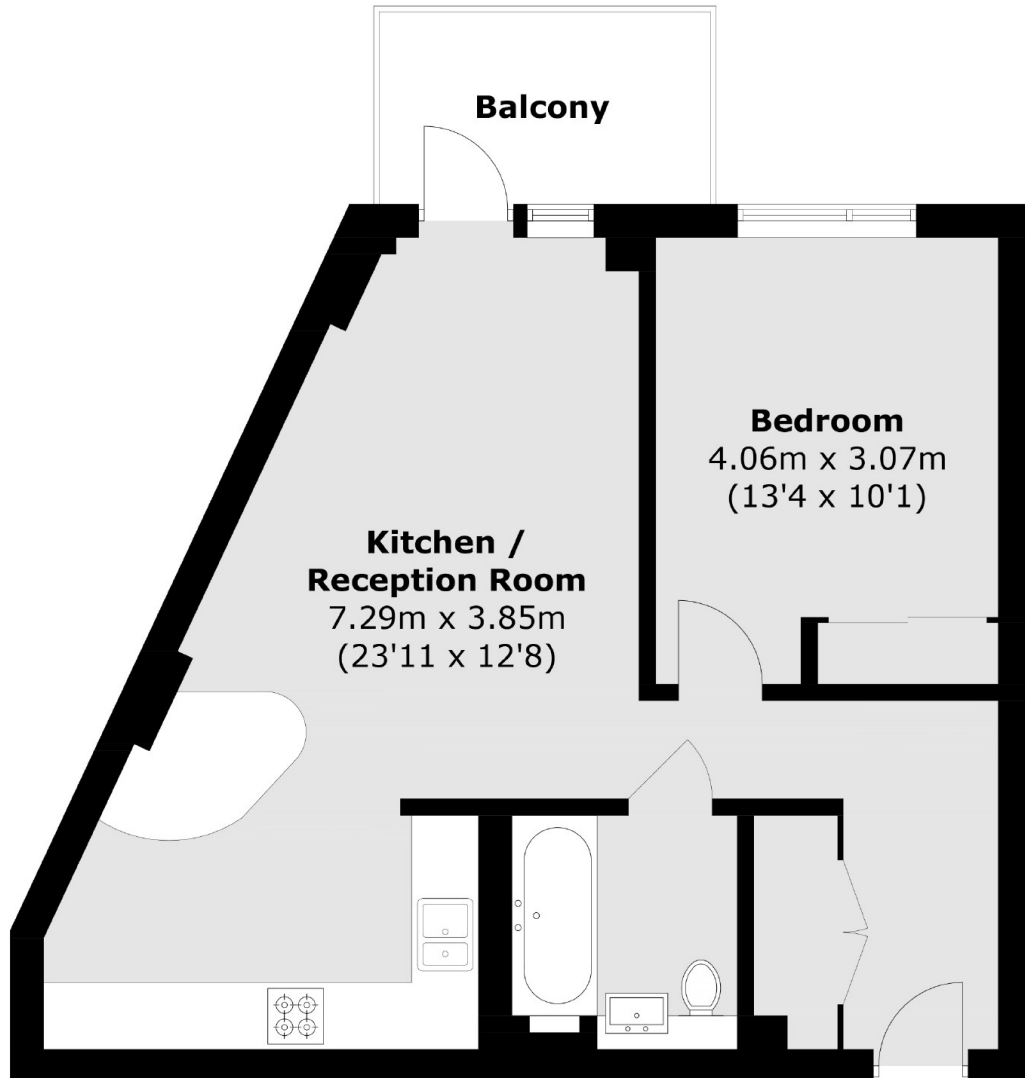

Total area (approx.): 53.4 sq. m (574.8 sq. ft)  
Balcony area: 5.1 sq. m (54.9 sq. ft)