



Maygrove Road, NW6

£968 Per week

A stunning three double bedroom, two bathroom apartment with a balcony within this excellent new development that has use of a private gym, lift and concierge.

Maygrove Road is located between West End Lane and Kilburn High Road. West Hampstead Thameslink, Overground and Jubilee Line is just over quarter of a mile and there is a large selection of shops, restaurants and bars on West End Lane.

Features

- Three Double Bedrooms
- Two Bathrooms
- Balcony
- Large Reception
- Open Plan Kitchen
- Gymnasium

Maygrove Road, London, NW6

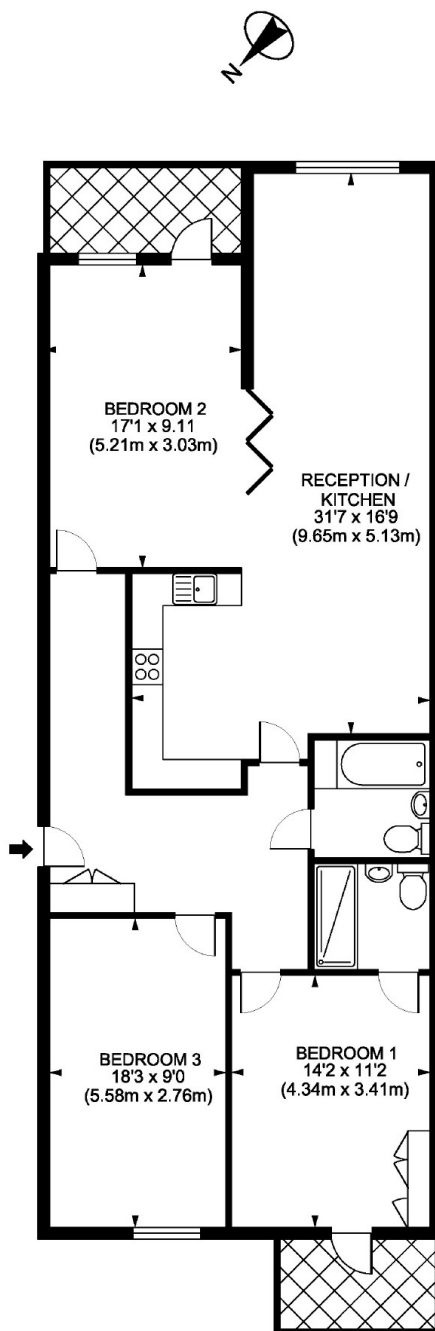

Beaufort Court, London, NW6

Gross Internal Area 1194 sq ft/111sq metres

Whilst every attempt has been made to ensure the accuracy of the floorplan shown, all measurements, positioning fixtures, fittings and any other data shown are an approximate interpretation for illustrative purposes only and are not to scale. No responsibility is taken for any error, omission, mis-statement or use of data shown.

Dexters

West Hampstead Lettings
106 West End Lane
London
NW6 2LS
Lettings
020 7644 9301

Energy Rating: B. We aim to make our particulars both accurate and reliable. However they are not guaranteed; nor do they form part of an offer or contract. If you require clarification on any points then please contact us, especially if you're traveling some distance to view. Please note that appliances and heating systems have not been tested and therefore no warranties can be given as to their good working order.

 **RICS** | Regulated
Estate Agent
and Letting Agent

dexters.co.uk