



## Mile End Road, E1

### £280,000

A bright one bedroom apartment located on the top floor of this purpose built block. The apartment benefits from a South facing open plan kitchen/living room which leads onto the private balcony.

The property is a short walk from a range of shops and amenities that can be found on Mile End Road such as the Genesis Cinema and numerous shops, cafés and restaurants. Stepney Green Station is a short walk away with Bethnal Green and Whitechapple stations are also within close proximity for links around the city.

### Features

Chain Free  
Open Plan  
Top Floor  
South Facing  
Chain Free  
Dual Aspect

# Mile End Road, London, E1

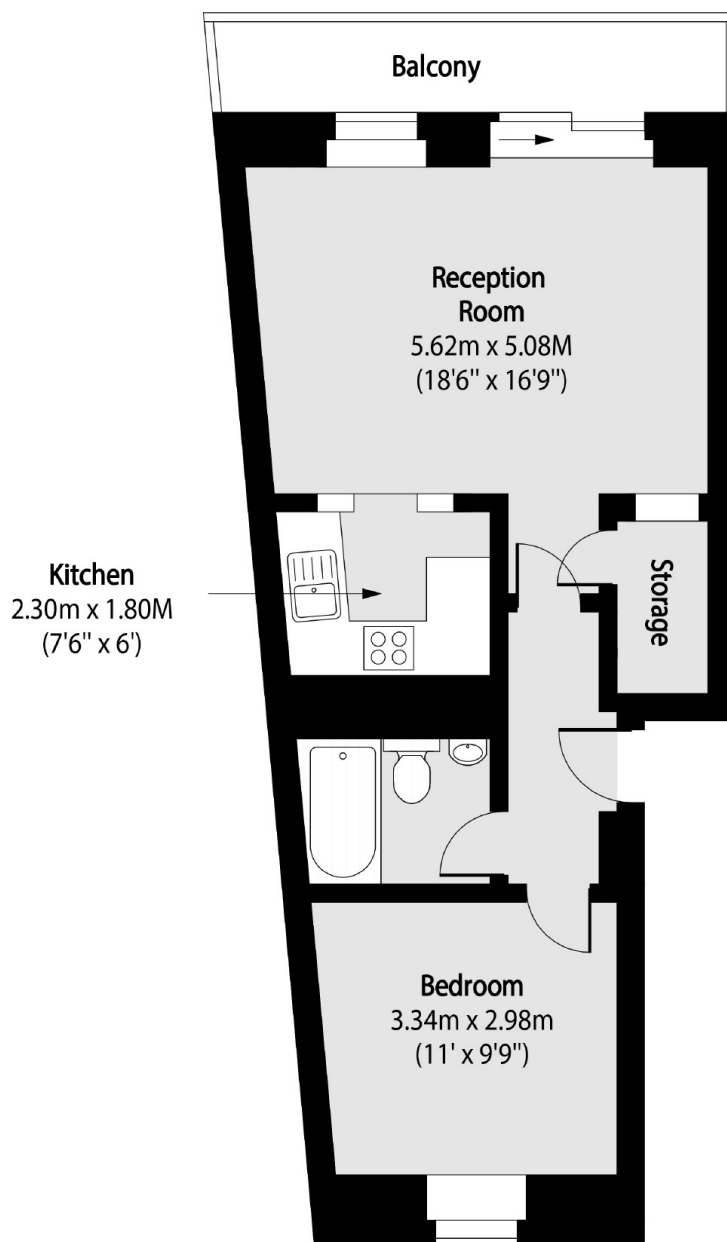

Total area (approx): 46.78 sq m (504 sq. ft)

Balcony total area (approx): 5.60 sq m (60 sq. ft)