



Nursery Lane, E2

£570,000

A two bedroom property located on the popular Nursery Lane. This property features a good sized living area with a private balcony overlooking Regent's Canal, a separate kitchen with built in appliances and space to dine, two double bedrooms and a family bathroom.

Amber Wharf is located near both Haggerston & Hoxton Overground stations, both under 0.4 miles walk, offering direct routes to Highbury & Islington, Shoreditch, Liverpool St and Canada Water as well as good bus links. Local parks are in abundance with Haggerston Park and Shoreditch Parks within a short stroll. Close to an array of amenities that the area is renowned for including many independent and large retail stores, pubs, coffee shops, bars and restaurants.

Features

- Two Bedrooms
- Canal Views
- Private Balcony
- Separate Kitchen
- Dual Aspect
- Built In Storage

Nursery Lane, London, E2

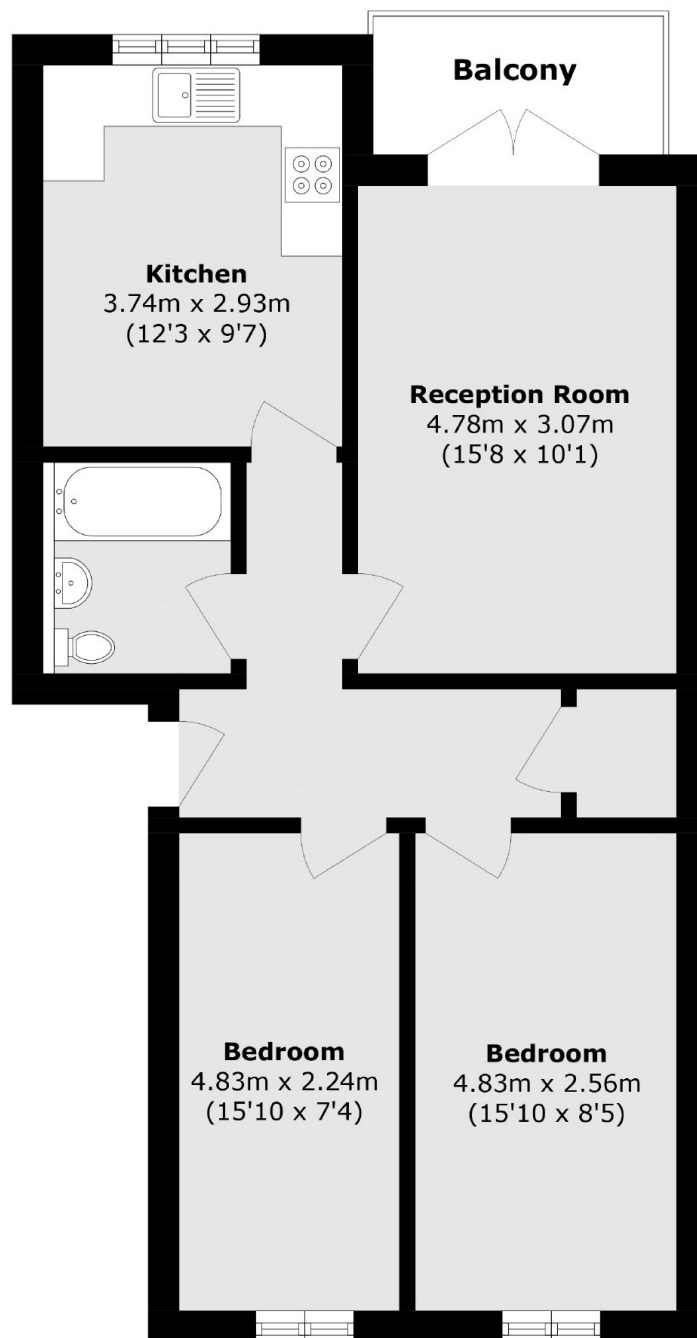

Total area (approx.): 63.4 sq. m (682.4 sq. ft)

Balcony area (approx.): 4.1 sq. m (44.1 sq. ft)