



## Osier Street, E1

### £475,000

A two double bedroom apartment located within the 1930's Art Deco block Osier Court. This ground floor flat offers a good sized reception room with access to a large private terrace, a separate kitchen, two double bedrooms and family bathroom. The property retains many of the original features including wooden flooring, high ceilings and Crittal Windows, and offers secure entry.

Osier Court is located on a quiet residential street and is 0.1 miles from Stepney Green Tube Station and under half a mile to Bethnal Green Tube Station. Whitechapel Station is 0.6 miles away for access to the new Elizabeth Line.

### Features

- Two Double Bedrooms
- Art Deco
- Balcony
- Recent Lease Extension
- Crittal Windows
- Chain Free

# Osier Street, London, E1

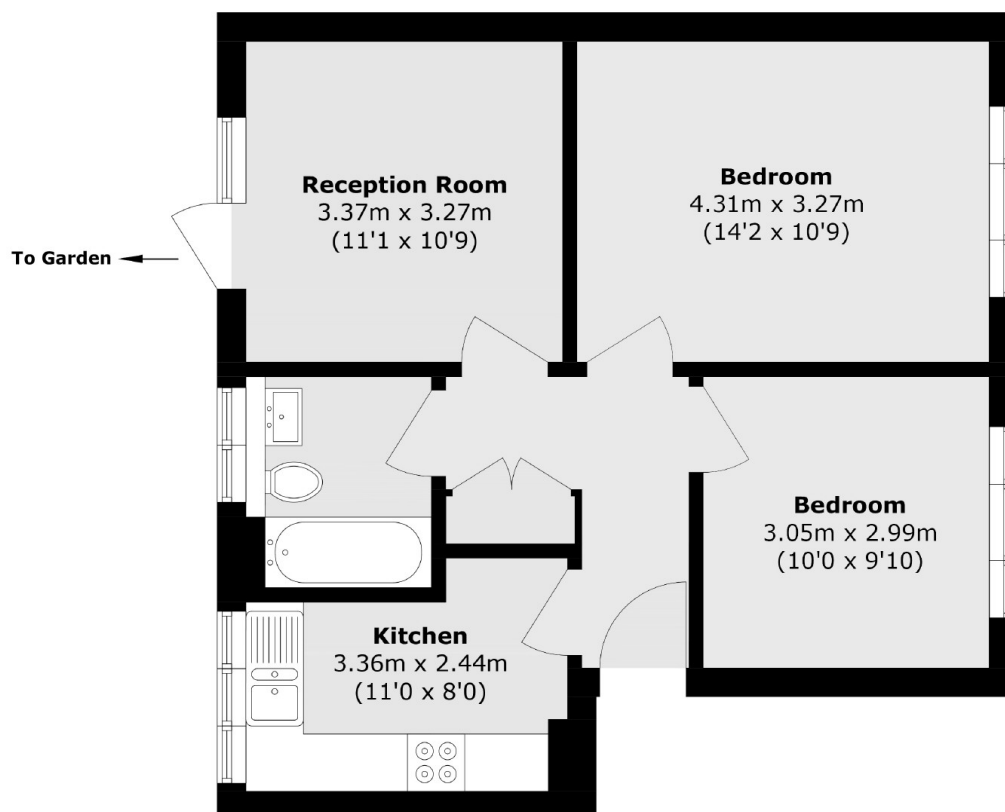

Total area (approx.): 55.3 sq. m (595.2 sq. ft)