



## Prescot Street, E1

### £450,000

A one bedroom fifth-floor apartment located within this historic brick-built art deco listed building (constructed in 1938 and converted to residential use in 1997). This bright, south-facing flat features a large living room with space to dine, a separate kitchen with fully integrated appliances, a large double bedroom with in-built storage and family bathroom. The development benefits from a 24/7/365 concierge, established management team, and one dedicated and secure parking space.

Located within a short walk of the City of London. Tower Hill, Aldgate, Aldgate East and Tower Gateway stations all near by, providing excellent transport links for commuters. It is also within close proximity of St. Katharine Docks, Tower Bridge, Tower of London, Shoreditch, Spitalfields and the Thames, providing an array of local amenities.

### Features

- One Bedroom
- 24 Hour Concierge
- South-facing, Inner Garden-side Elevation
- Parking
- Great Location
- Local Amenities Nearby

Prescot Street,  
London, E1

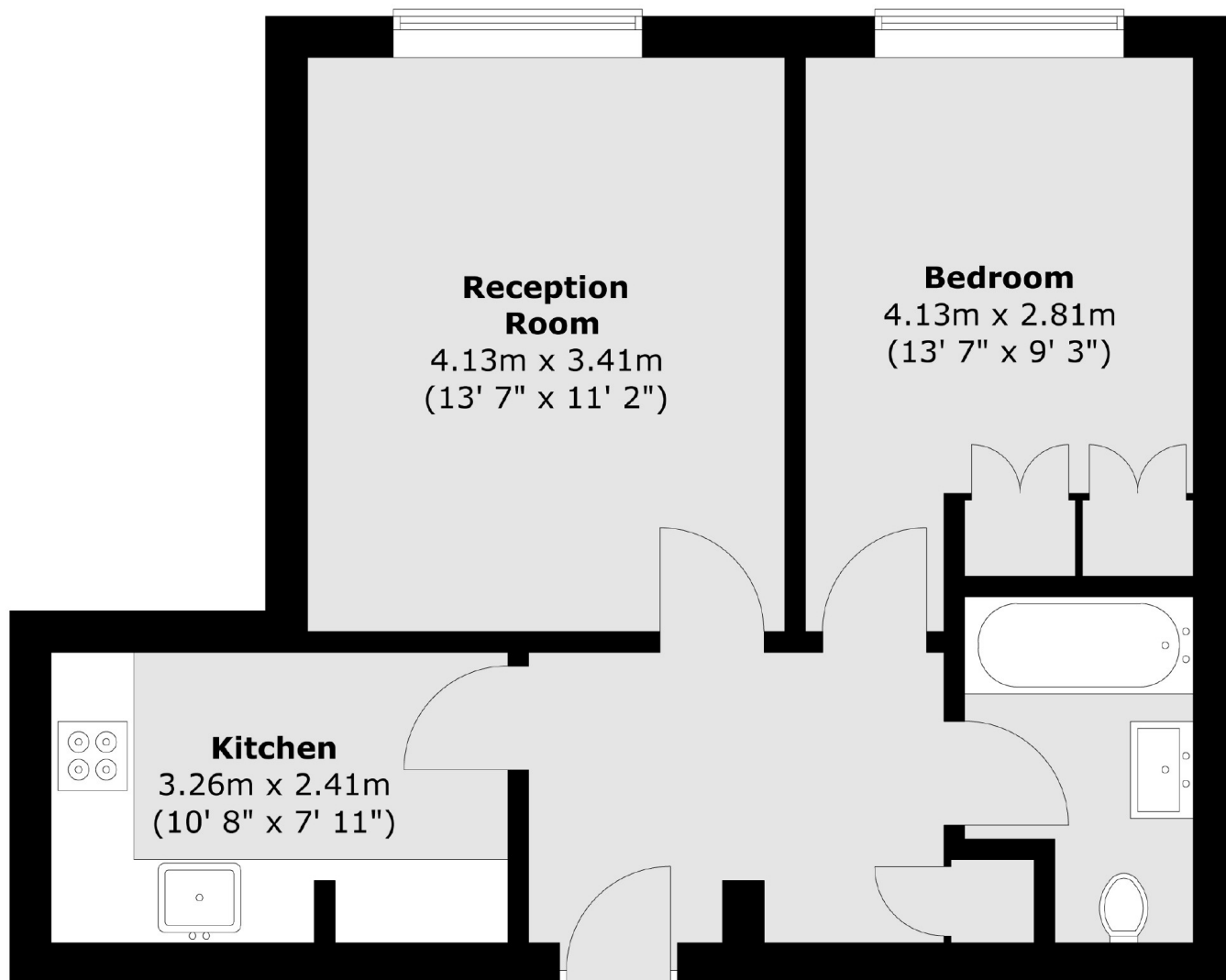

Total area (approx.) : 46 sq. m (495 sq. ft)