



## Columbia Road, E2

### £400,000

A one bedroom apartment located on the iconic Columbia Road. This property offers a separate kitchen and reception space, featuring large windows and plenty of built in shelving, a double bedroom and a family bathroom. This flat provides plenty of space and natural light throughout.

Located directly on Columbia Road, just moments from Columbia Road Flower Market, this property offers unmatched access to the cafés, bars and unique shopping opportunities that the area has to offer. Nearby Hoxton (Windrush line) and Bethnal Green (Central line) provide easy access throughout the City.

### Features

- One Double Bedroom
- Great Location
- Period Building
- Separate Kitchen
- Close to Amenities
- Natural Light

# Columbia Road, London, E2

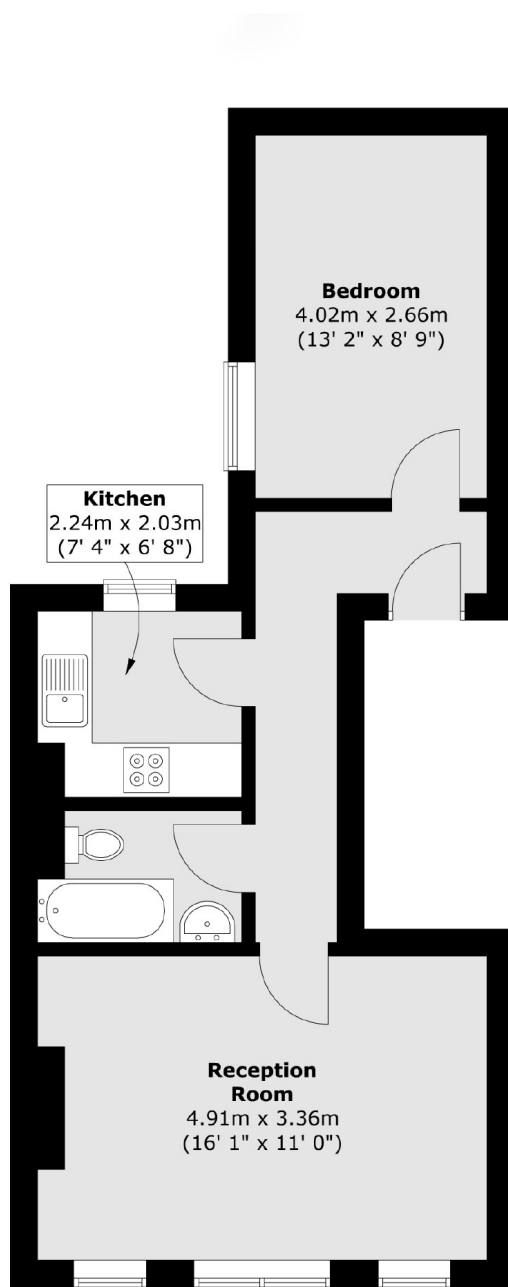

Total area (approx.) : 42.3 sq. m (455 sq. ft)

## Dexters

Shoreditch  
44 Great Eastern Street  
London  
EC2A 3EP  
Sales  
0207 483 6371

Energy Rating: . We aim to make our particulars both accurate and reliable. However they are not guaranteed; nor do they form part of an offer or contract. If you require clarification on any points then please contact us, especially if you're traveling some distance to view. Please note that appliances and heating systems have not been tested and therefore no warranties can be given as to their good working order.

 **RICS** | Regulated  
Estate Agent  
and Letting Agent

[dexters.co.uk](https://www.dexters.co.uk)