



## Hague Street, E2

£450,000

A top-floor, two-bedroom apartment located in Weavers Court. This dual aspect property consists of a bright living room with large windows and inbuilt shelving, and a separate, modern kitchen. This flat also provides two good-sized bedrooms and a contemporary family bathroom. Residents also benefit from a large communal roof terrace.

Weavers Court is in a sought after location, a short distance from multiple tube stations and bus routes such as Bethnal Green, Shoreditch High Street and Cambridge Heath Stations. The famous Columbia Road flower market and the vibrant Broadway Market are both within easy reach offering an array of restaurants, bars and shops as well as the green spaces of Victoria park.

### Features

- Communal Roof Terrace
- West Facing
- Top Floor
- Double Bedrooms
- Prime Location
- Separate Kitchen

Hague Street,  
London, E2

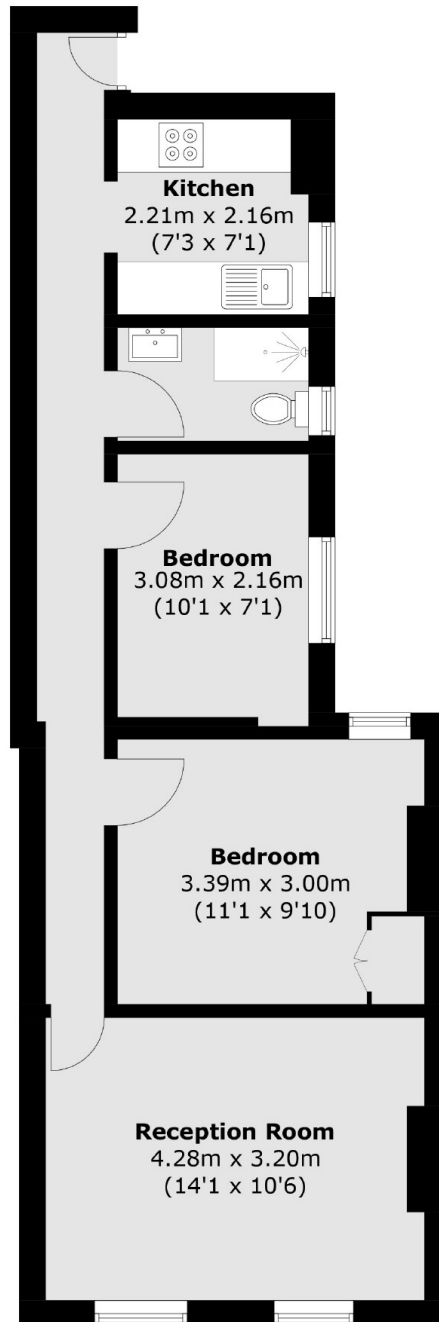

Total area (approx.): 49.5 sq. m (532.8 sq. ft)

**Dexters**

Shoreditch  
44 Great Eastern Street  
London  
EC2A 3EP  
Sales  
0207 483 6371

Energy Rating: C. We aim to make our particulars both accurate and reliable. However they are not guaranteed; nor do they form part of an offer or contract. If you require clarification on any points then please contact us, especially if you're traveling some distance to view. Please note that appliances and heating systems have not been tested and therefore no warranties can be given as to their good working order.

 **RICS** | Regulated  
Estate Agent  
and Letting Agent

[dexters.co.uk](https://www.dexters.co.uk)