



## Mansford Street, E2

### £575,000

Three bedroom property arranged over two floors set within this popular location. The entrance level consists of a large open plan living area with plenty of space to dine, a recently modernised kitchen with integrated appliances and a breakfast bar, and a WC. The first floor provides three bedrooms, two of which are large doubles whilst the third is a generous single, as well as a modern family bathroom and plenty of additional storage on the landing. The property benefits from a vast amount of natural light made possible by the property's large east facing windows.

Set on a quiet residential road, the apartment is a short walk from Hackney Road, Shoreditch High Street and Bethnal Green. There is a wide array of local amenities including pubs/bars/restaurants and grocery stores. Nearby transport links include Bethnal Green Station (Central Line), Cambridge Heath Station (Overground), Shoreditch High Street Station (Overground) and plenty of local bus services.

### Features

- Bespoke Halo Radiators
- Bosch and Smeg Integrated Kitchen Appliances
- Polished Concrete Flooring for Living Space
- Parquet Herringbone Karndean Flooring to Bedrooms and Upstairs
- Stylish Shower Room
- Bright and Modern Accommodation
- Purpose Built Development

# Mansford Street, London, E2

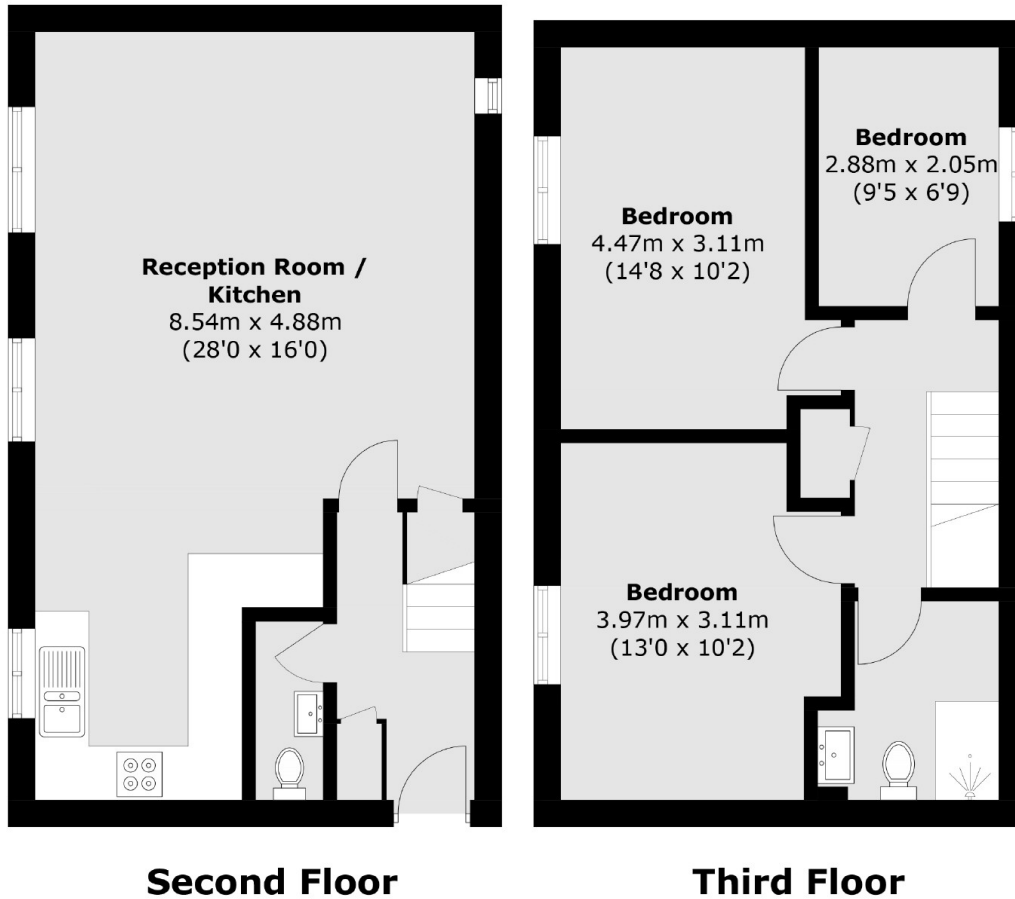

Total area (approx.): 82.5 sq. m (888.0 sq. ft)