



## Dunbridge Street, E2

### £425,000

This one-bedroom apartment is on the ground floor of The Bath House. A converted, Grade II-listed Victorian building formally, the Cheshire Street Baths in Bethnal Green. The property is accessed through the gated courtyard and enters onto the large open plan living area, with a fully integrated kitchen and space to dine. The hallway features built in storage and leads onto the family bathroom and a spacious double bedroom with elevated ceiling height and sashed windows.

Bath House offer a convenient Bethnal Green location with easy access to Brick Lane, Shoreditch and the City. Transport links include Bethnal Green (Windrush, Central) and Whitechapel (Elizabeth, District, Hammersmith&City) for simple commute to all corners of the City and beyond. The green spaces of Weavers Fields and Spitalfields City Farm are also close by.

### Features

- Grade II Listed Development
- Private Entrance
- Gated Development
- Bright Interiors
- Secure Parking Space
- Bike Storage

# Dunbridge Street, London, E2

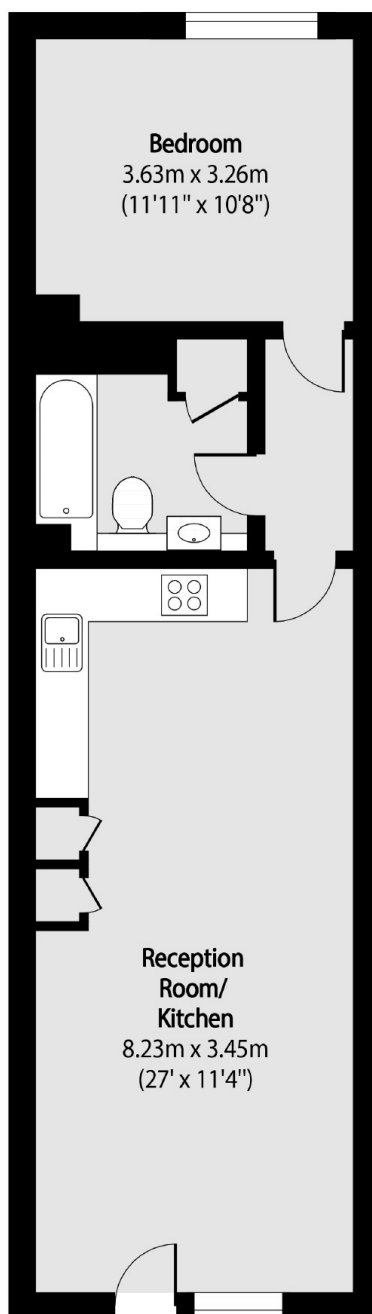

Total area (approx): 51.12 sq m (550 sq. ft)