



Leman Street, E1

£500,000

A one bedroom, one bathroom property located in a secluded development on the edge of the City of London. This property offers a spacious, semi-open plan reception/kitchen with floor to ceiling doors leading onto the private balcony overlooking the Four Seasons garden. The double bedroom provides built in storage, with additional storage in the hallway. The development has its own concierge and 24/7 security.

This central location provides great transport links throughout London with a short walk to Algate East (Hammersmith & City, District), Aldgate (Circle, Metropolitan), Liverpool Street (Underground, Overground and Mainline) and Shadwell (Windrush, DLR). The local area offers fantastic amenities including several bars, cafes, restaurants, gyms and a luxury cinema."

Features

- One Double Bedroom
- Private Balcony
- Separate Kitchen
- Built In Storage
- Great Transport Links
- Modern Design

Leman Street, London, E1

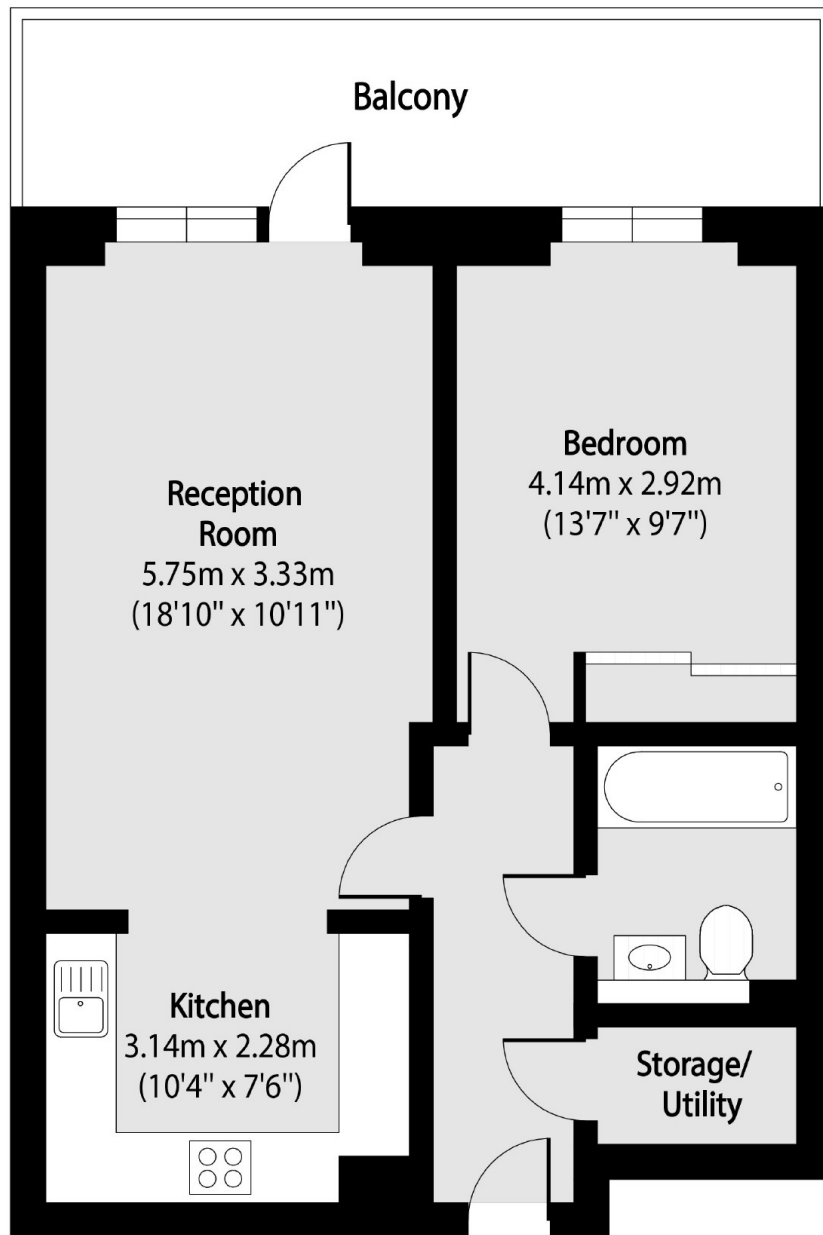

Total area (approx): 51.33 sq m (553 sq. ft)

Balcony total area (approx): 10.88 sq m (117 sq. ft)