



Principal Tower, EC2A

£700,000

A one bedroom apartment in Principal Tower with unobstructed east-facing views. The apartment comprises a spacious open plan living room with a high spec fully integrated kitchen, this area leads out onto the private balcony with far reaching views. The apartments double bedroom has slick built in storage and an en-suite. The apartment has floor to ceiling windows throughout allowing for a generous amount of natural light. Principle Tower is one of the area's most sought-after residential developments, in part due to features including the 24-hour concierge, residents' gym, pool, sauna and steam room, as well as communal meeting areas.

Principal Tower is on the fringe of the City, just moments from Liverpool Street Station and Shoreditch High Street Overground. The development is also very close to a number of popular bars and restaurants in the area, as well as Spitalfields Market.

Features

- One double bedroom
- High spec finish
- 18th Floor
- Private balcony
- Exclusive health club
- Concierge

Principal Tower, London, EC2A

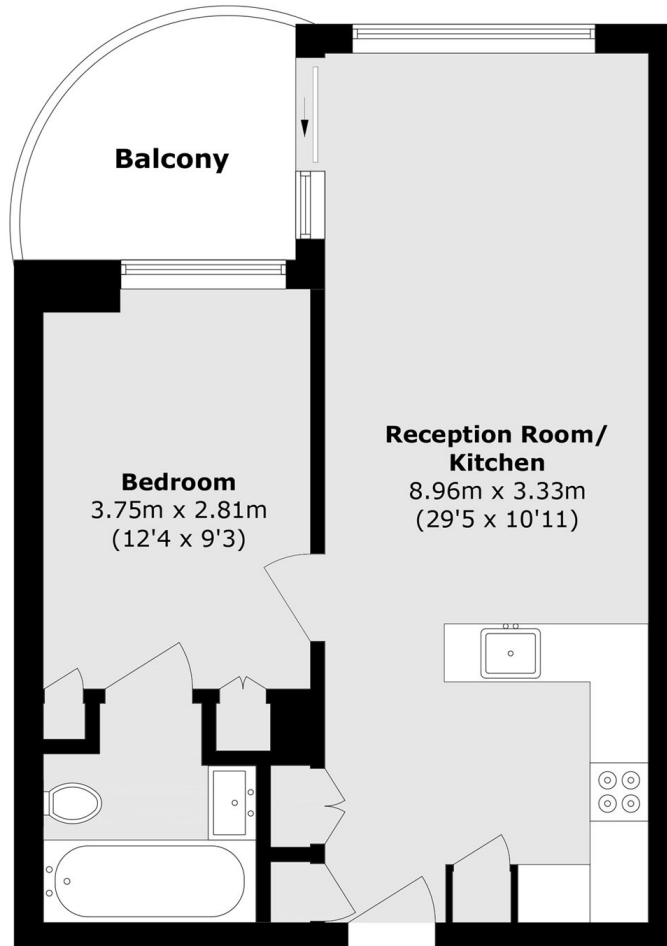

Total area (approx.): 48.7 sq. m (524.2 sq. ft)

Balcony area (approx.): 6.1 sq. m (65.6 sq. ft)