



Twig Folly Close, E2 £400,000

A spacious one bedroom apartment set within this popular gated, canalside development. Presenting a modern kitchen, separate living room, double bedroom and bath & shower room. The flat is light and airy and has an allocated parking space in a gated car park and well maintained communal gardens

The flat is in easy reach of a range of transport options that take you into the heart of London as well as across East London. The property is minutes away from Victoria Park and the vibrant restaurants, shops and entertainment of Hackney, Shoreditch and Hoxton.

Features

- OIEO
- Gated Development
- Canal side
- One Double Bedroom
- Separate Kitchen
- Off Street Parking
- Communal Gardens

Twig Folly Close, London, E2

Ground Floor

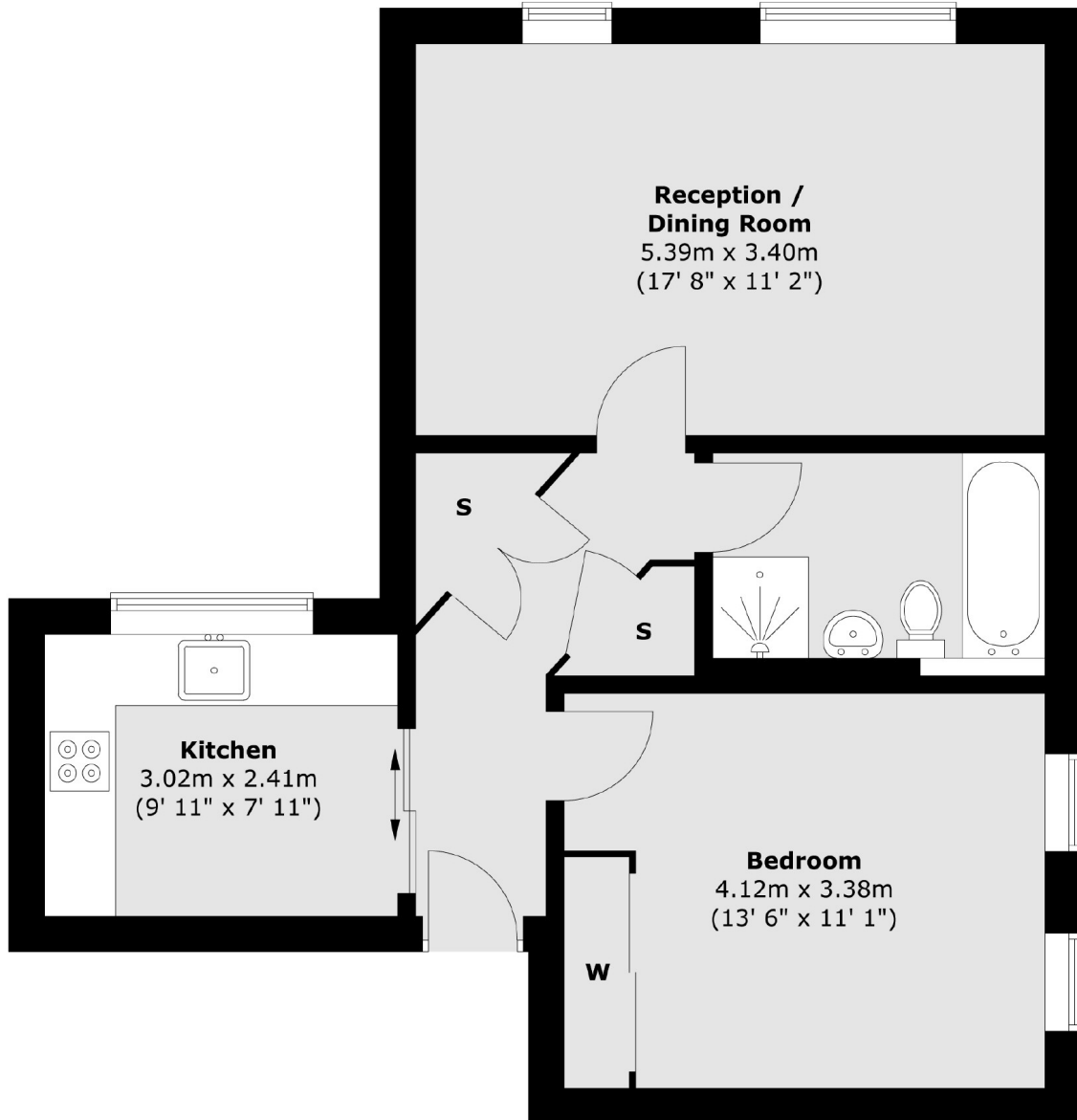

Total area (approx.) : 54.1 sq. m (582 sq. ft)