



Newark Street, E1

£425,000

Two bedroom apartment on the top floor set within a sought after location. The apartment, located on the top floor, has a spacious, open plan living room with ample space to dine and a fully integrated kitchen. The living area leads out to the properties private balcony which is sizeable enough for a table and chairs and has good views from its elevated position. The apartment has two double bedroom, one of which with in-built storage, plenty of further storage in the hallway and a modernised bathroom.

Situated in the heart of Whitechapel, the development benefits from a wide range of transport links, with Whitechapel station just a short walk away providing access to the Elizabeth Line, District, Hammersmith & City, and London Overground services. The area has an array of popular bars, restaurants and entertainment venues within a short distance in the City and Shoreditch.

Features

- Two bedrooms
- Private balcony with views
- Modern interiors
- Sought after location
- Plenty of storage

Newark Street, London, E1

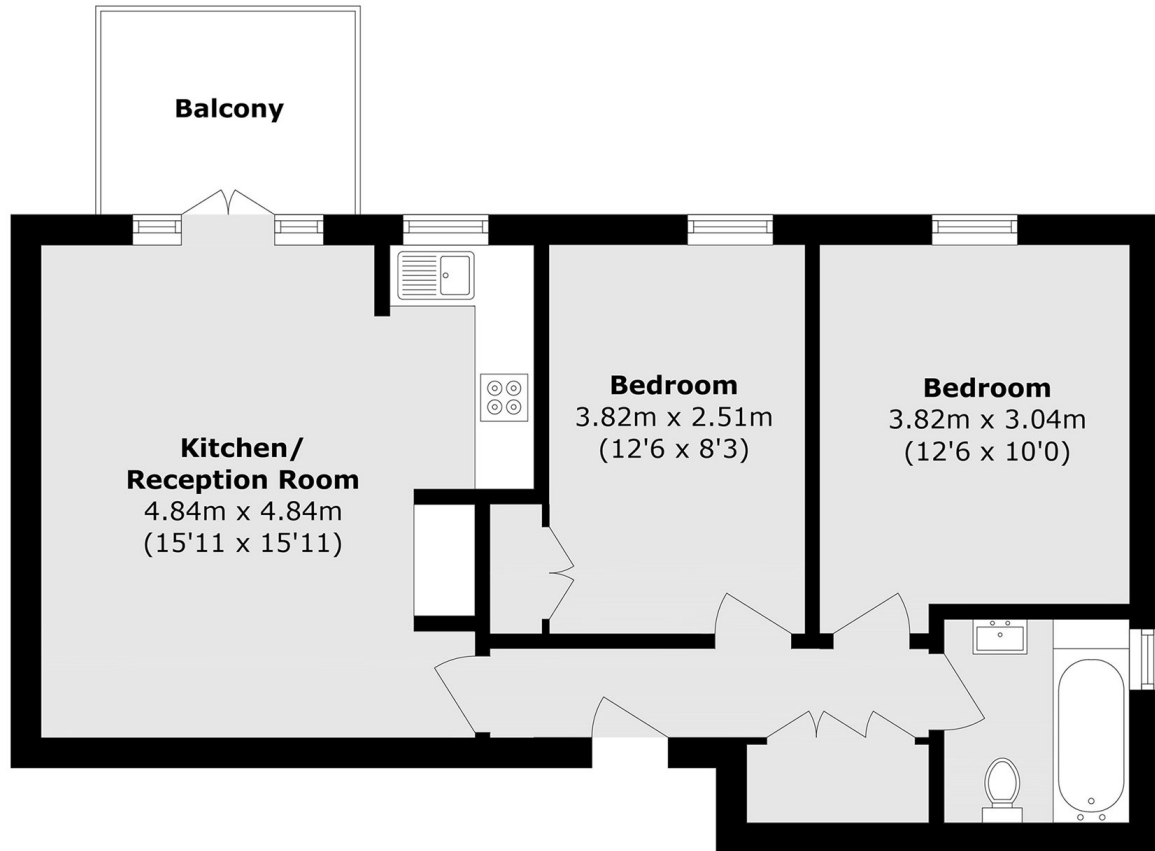

Total area (approx.): 54.8 sq. m (589.8 sq. ft)

Balcony area (approx.): 5.0 sq. m (53.8 sq. ft)