



## Victoria Park Square, E2 £400,000

One-bedroom apartment, recently renovated throughout and situated in a sought-after location. The property features a spacious, bright living room with ample room for dining, which leads to a separate, modern, fully integrated kitchen. There is a generously sized double bedroom, a contemporary bathroom, and additional storage throughout. The apartment also benefits from an abundance of natural light.

Montfort House is situated on the impressive, tree-lined Victoria Park Square, overlooking the Museum Gardens. The property benefits from excellent transport links, with Bethnal Green Underground Station (Central Line) just a short walk away. In addition to its convenient location for transport, there is a wide range of local amenities within easy reach, including the renowned York Hall public baths at the end of the road, as well as the open green spaces of Victoria Park nearby.

### Features

- One Bedroom Apartment
- Bright, Modern Interiors
- Separate Kitchen
- Sought After Location
- Great Transport Links
- Close to Victoria Park Square

# Victoria Park Square, London, E2

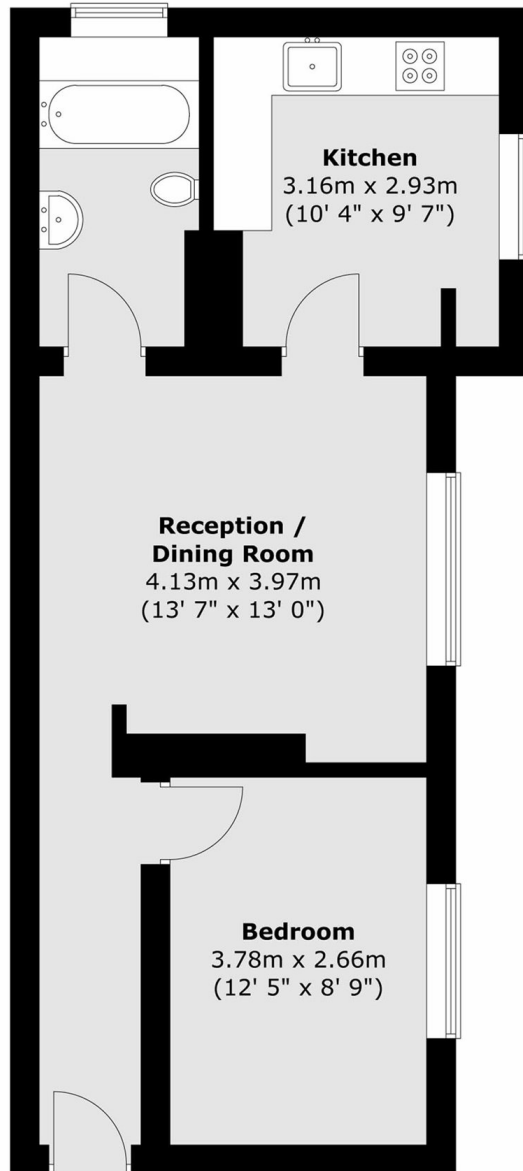

Total area (approx.) : 48.4 sq. m (521 sq. ft)