



Fulham Road, SW10

£515,000

A one double bedroom apartment located on the raised ground floor of this Victorian mansion block. The apartment has been recently refurbished and is therefore in excellent condition throughout.

Located on the Fulham Road in Chelsea and only a short distance from a wide variety of the local amenities in Fulham and Kings Road. The closest station is Fulham Broadway.

Features

- One Bedroom
- One Bathroom
- Excellent Condition
- High Ceilings
- Victorian Mansion Block
- Fulham Broadway Station

Fulham Road, London, SW10

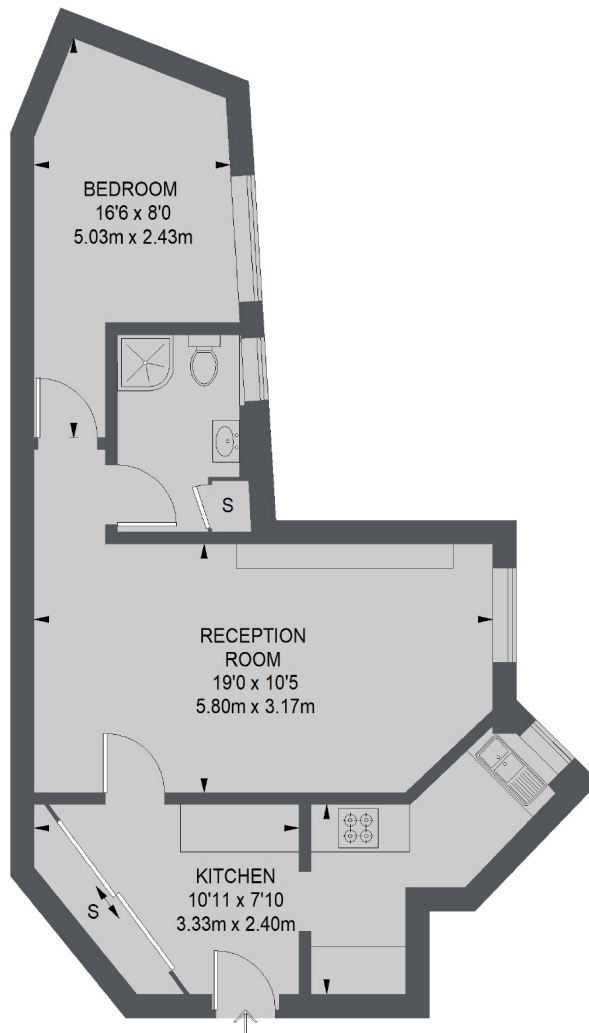

TOTAL APPROX. FLOOR AREA
506 SQ. FT. (47.0 SQ. M.)

Contact

To arrange a viewing call our office on the number below or visit our website.



Energy Rating: D. We aim to make our particulars both accurate and reliable. However they are not guaranteed; nor do they form part of an offer or contract. If you require clarification on any points then please contact us, especially if you're traveling some distance to view. Please note that appliances and heating systems have not been tested and therefore no warranties can be given as to their good working order.