



JULIE TWIST
PROPERTIES



Burton Place, Castlefield, Manchester – Offers Over £140,000

Burton Place is an Urban Splash development which is located in Castlefield, only a ten minute walk away from Deansgate.

Set on the fourth floor, this one bedroom apartment has been innovatively designed to utilise every inch of space. The property comprises of an entrance hallway with boiler cupboard and storage cupboard, three piece bathroom, living room which leads onto the full-length balcony, separate kitchen with integrated appliances and a double bedroom with built-in wardrobes.

Burton Place is located just off Ellesmere Street which is home the Banyan Tree bar and restaurant, a convenience store and other small businesses. The Slate Wharf area of Castlefield is just a five minute walk away providing you with plenty of other bars and restaurants. The property is located only a five minute walk from Cornbrook Metrolink stop which connects you to Salford Quays and South Manchester. Located right on the edge of the main inner city ring road Trinity Way, it also offers great motorway links out of the city centre.

- One Double Bedroom
- Balcony
- Secure Allocated Parking
- Castlefield Location
- Fourth Floor
- 10 Minute Walk to Deansgate
- 5 Minutes Walk to Main Hub of Castlefield
- 5 Minutes Walk to Cornbrook Metrolink Stop

GENERAL

Rental Yield: 6.4% (Based on expected rental of £750pcm)

Service Charge: £1200pa (approx)

Ground Rent: £200pa (approx)

Lease: 999 years from 01.01.2003

Council Tax Band: B, Aprx £1218.61 pa

Management Company: Mainstay

Please note there is also a charge payable when selling the property which will contribute towards the maintenance fund. This is 0.25% (of the resale value) multiplied by a minimum of 4 or the number of years you have owned the property for.

HALLWAY

Wooden flooring, boiler cupboard, intercom entry phone and spotlights.

LIVING ROOM

Double glazed sliding door to balcony, wooden flooring, phone/tv point, two wall mounted heater and spotlights.

KITCHEN

Tiled flooring, integrated fridge with freezer compartment, stainless steel sink with mixer tap, work surface with drainer grooves, base and wall units, stainless steel splashback, four ring hob with extractor over and spotlights.

BEDROOM

Carpeted flooring, wall mounted heater, built-in wardrobe, double glazed window into communal hallway and spotlights.

BATHROOM

Three piece bathroom comprising bath with shower attachment over, WC, sink with mixer tap, heated towel rail, tiled flooring, spotlights and vanity mirror.

BALCONY

Accessed from the living room, the balcony comprises decking and glass balustrade

PARKING

This property comes with one secure allocated parking space.

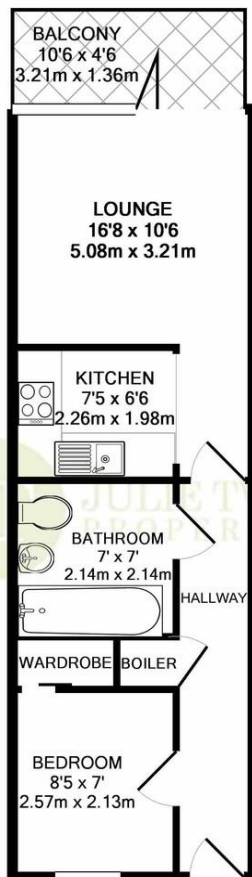

TOTAL APPROX. FLOOR AREA 376 SQ.FT. (34.9 SQ.M.)

Whilst every attempt has been made to ensure the accuracy of the floor plan contained here, measurements of doors, windows, rooms and any other items are approximate and no responsibility is taken for any error, omission, or mis-statement. This plan is for illustrative purposes only and should be used as such by any prospective purchaser. The services, systems and appliances shown have not been tested and no guarantee as to their operability or efficiency can be given.
Made with Metropix ©2018

IMPORTANT NOTE TO PURCHASERS: We endeavour to make our sales particulars accurate and reliable, however, they do not constitute or form part of an offer or any contract and none is to be relied upon as statements of representation or fact. The services, systems and appliances listed in this specification have not been tested by us and no guarantee as to their operating ability or efficiency is given. All measurements have been taken as guide to prospective buyers only, and are not precise. If floor plans were included, these may not be to scale and accuracy is not guaranteed. If you require clarification or further information on any points, please contact us, especially if you are travelling some distance to view.

