

JULIAN WADDEN



Apartment 13 Metropolitan House, Brindley Road,
£600 Per calendar month



Apartment 13 Metropolitan House | Stretford

A stunning one bedroom ground floor apartment to rent in a new development close to Salford Quays in Metropolitan House. Metropolitan House is located close to the Old Trafford football stadium and Media City UK, with excellent transport links into Manchester City Centre by tram, bus and road as the property is close to the A56. The property has just been completely refurbished and benefits from a large open plan kitchen living area with a modern grey kitchen including an electric hob and oven, a double bedroom and a large bathroom with three piece bathroom suite including a shower over a bath. The property is offered on a flexible basis in terms of furnishings and can be furnished or unfurnished. The property is available to rent immediately. Unfortunately this property cannot accept tenants with pets, but it would be a great home for single professionals, couples or a small family!

Square Footage: 479

Council Tax Band: A

Sat Nav Directions: M16 9HQ

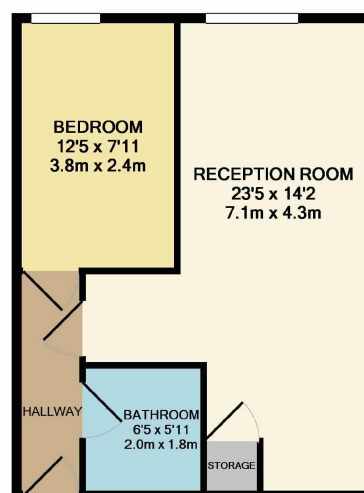

TOTAL APPROX. FLOOR AREA 408 SQ.FT. (37.9 SQ.M.)

Whilst every attempt has been made to ensure the accuracy of the floor plan contained here, measurements of doors, windows, rooms and any other items are approximate and no responsibility is taken for any error, omission, or mis-statement. This plan is for illustrative purposes only and should be used as such by any prospective purchaser. The services, systems and appliances shown have not been tested and no guarantee as to their operability or efficiency can be given.

Made with Metropix ©2018

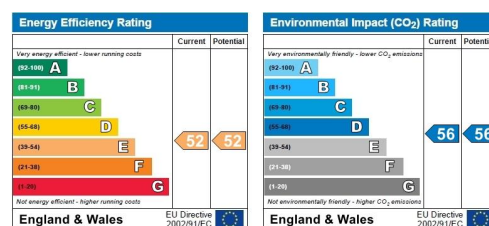

RESERVING A PROPERTY - CHARGES TO TENANTS

An administration fee equivalent to 60% of the rent inclusive of VAT will be payable upon your application being accepted. Should the tenancy not proceed this charge is non-refundable.

(For example, if the rent is £600 per calendar month the application fee would be £360 inclusive of VAT)

The balance of the deposit (1 months rent plus £150.00 unless otherwise stated) and the first months rent are required in cleared funds prior to the start date of the tenancy.

UNFORTUNATELY THIS PROPERTY DOES NOT ACCEPT APPLICATIONS FROM APPLICANTS IN RECEIPT OF BENEFITS

Stockport Exchange Branch

81-83 Wellington Road South, Stockport, SK1 3SL |

stockportlettings@julianwadden.co.uk | www.julianwadden.co.uk

**JULIAN
WADDEN**

FOR FACTS STATS AND ALL THINGS STOCKPORT VISIT
WWW.STOCKPORTPROPERTYBLOG.COM

rightmove

The Property
Ombudsman