



## BRX, Stockwell Road, SW9

£470,000

A one bedroom apartment home with a private balcony available on help to buy. The property is finished to an uncompromising standard with Karndean flooring throughout and a fully integrated kitchen including wine cooler.

Located at the start of the Victoria Line, in the electric heart of South London, this spectacular 20-storey development was built to stand out.

### Features

#### HELP TO BUY

- Private balcony
- Parking available
- Communal gardens
- Excellent transport links
- Cycle storage

## Stockwell Road, Brixton, SW9

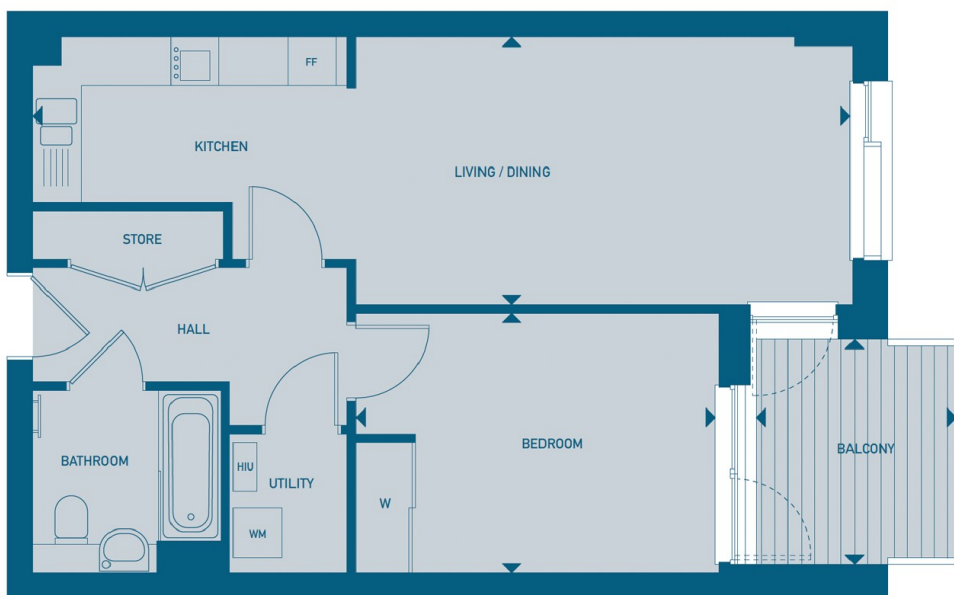

### Contact

To arrange a viewing call our office on the number below or visit our website.



Energy Rating: . We aim to make our particulars both accurate and reliable. However they are not guaranteed; nor do they form part of an offer or contract. If you require clarification on any points then please contact us, especially if you're traveling some distance to view. Please note that appliances and heating systems have not been tested and therefore no warranties can be given as to their good working order.