

Golden Lane, EC1Y

£740,000

Apartment 2 is a 569 Sq.Ft one bedroom apartment, offering open plan living and a private terrace. With impeccable interior design and attention to detail, The Denizen brings a fresh modern feel to Barbican.

The Denizen is a short distance from Farringdon Station which has access to National Rail, underground and the future Elizabeth Line taking you to Canary Wharf in 8 minutes and Heathrow in less than 35 minutes.

Features

- Private Terrace
- 24 Hour Concierge
- Residents Lounge
- Private Cinema Room
- Residents Garden
- Photos are indicative of finish

Golden Lane, London, EC1Y

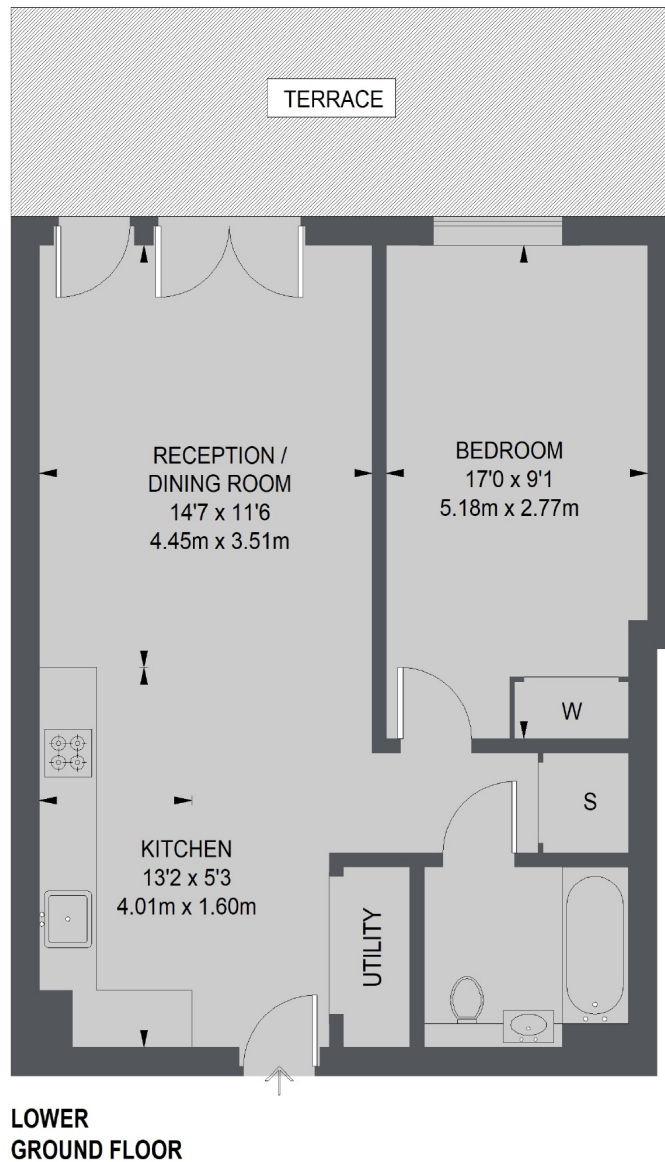

TOTAL APPROX. FLOOR AREA
569 SQ. FT. (52.9 SQ. M.)

Contact

To arrange a viewing call our office on the number below or visit our website.



Energy Rating: TBC. We aim to make our particulars both accurate and reliable. However they are not guaranteed; nor do they form part of an offer or contract. If you require clarification on any points then please contact us, especially if you're traveling some distance to view. Please note that appliances and heating systems have not been tested and therefore no warranties can be given as to their good working order.