



Asher Way, E1W

£425,000

Offered to the market on a chain free basis is this one bedroom home located within the popular Quay 430 development. The property includes private balcony, garage, allocated parking, concierge service and no onward chain.

Tower Bridge and St Katharine Docks are within easy reach, with Tower Hill, Aldgate and Wapping stations all easily accessible, providing excellent connections across London.

Features

- Gated Development
- Private Garage
- Allocated Parking
- Concierge Service
- Private Balcony
- No Onward Chain

Asher Way, London, E1W

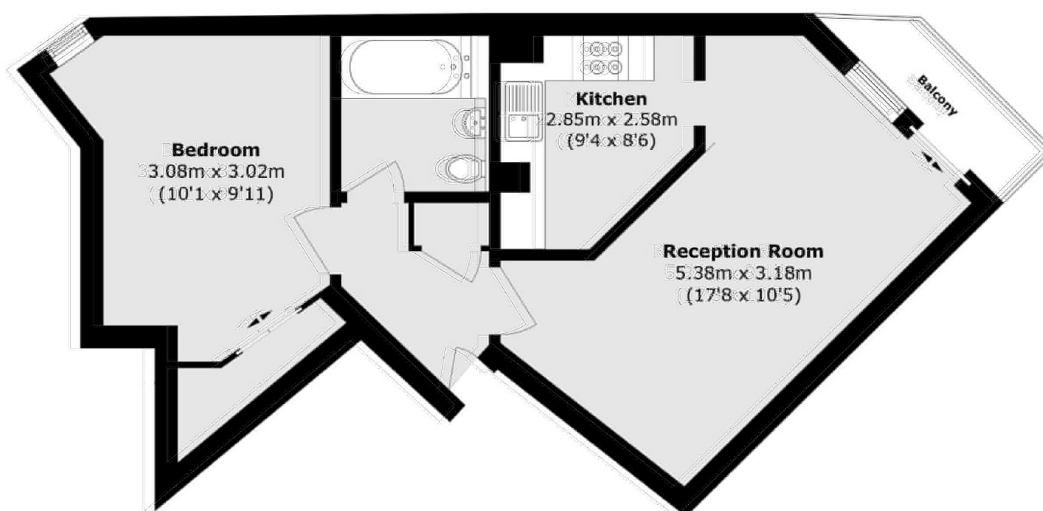

Total area (approx.): 49.1 sq. m (528.6 sq. ft)

Balcony area (approx.): 2.6 sq. m (28.0 sq. ft)

Dexters

Wapping
123 Wapping High Street
London
E1W 3NX
Sales
020 7650 5350

Energy Rating: D. We aim to make our particulars both accurate and reliable. However they are not guaranteed; nor do they form part of an offer or contract. If you require clarification on any points then please contact us, especially if you're traveling some distance to view. Please note that appliances and heating systems have not been tested and therefore no warranties can be given as to their good working order.

 **RICS** | Regulated
Estate Agent
and Letting Agent

[dexters.co.uk](https://www.dexters.co.uk)