



Victory Place, E14

£350,000

A one bedroom home located in the sought after Victory Place offered to the market on a chain free basis. The property includes allocated parking, concierge service, residents gym and private balcony.

Victory Place is just off Narrow Street next to Limehouse marina, which offers a variety of restaurants, bars and riverside pubs, as well as being only moments away from the picturesque Limehouse Marina and Thames Path. Transport links include Limehouse DLR and C2C stations and the Thames Clipper riverboat service, all of which offer excellent links into Canary Wharf, Greenwich and Central London.

Features

- Gated Development
- 563 Square Feet
- Allocated Parking
- Concierge Service
- Residents Gym
- No Onward Chain

Victory Place, London, E14

First Floor

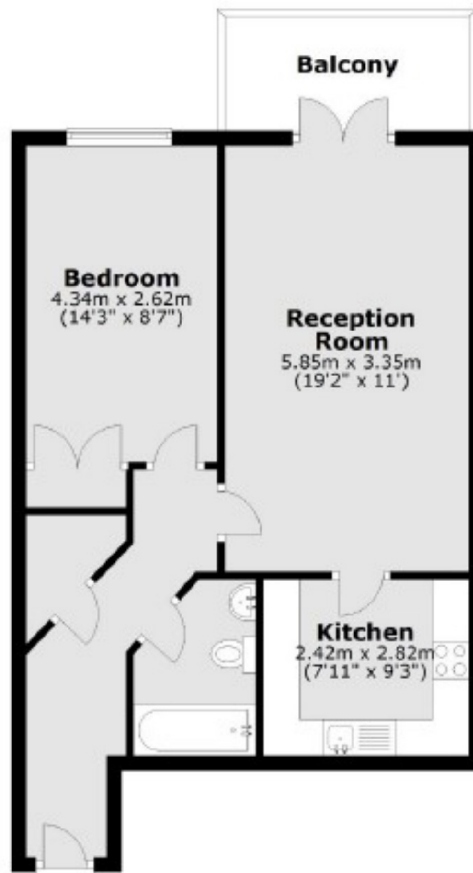

Total area: approx. 52.3 sq. metres (563.4 sq. feet)