



William Morris Way, SW6

£660 Per week

A beautifully presented two double bedroom apartment with direct views of the River Thames, underground parking and private balcony.

Located on the north side of the River Thames, William Morris Way is in close proximity to Imperial Wharf station and local amenities.

Features

- Two Double Bedrooms
- One Bathrooms
- Available July
- River Views
- Heating and Hot Water Inc
- Underground Parking

William Morris Way, London, SW6

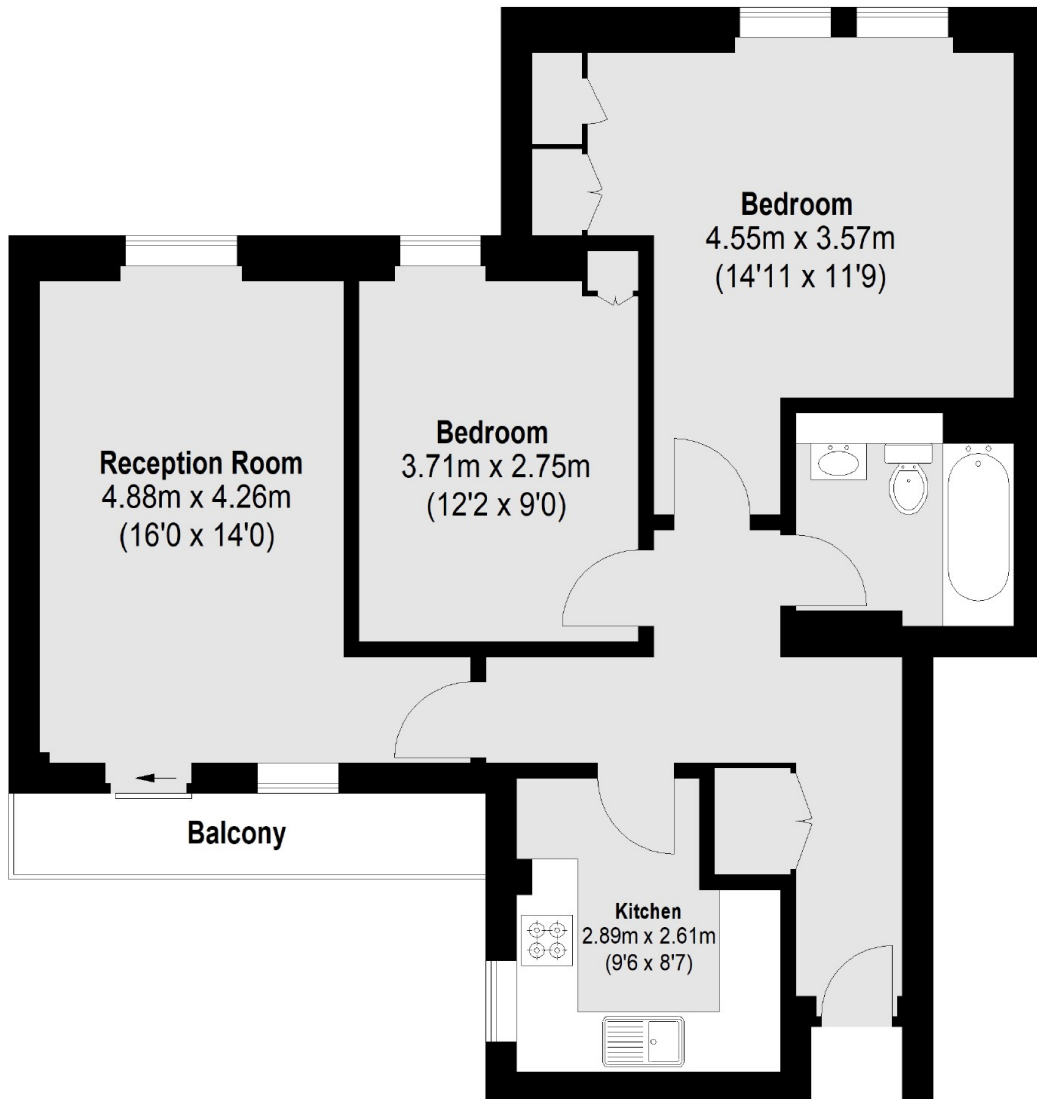

Total area (approx.): 67.26 sq. m (724 Sq. ft)
Balcony : 3.72 sq. m (40 Sq. ft)