



## Earlsfield Road, SW18

### £799,950

\* Chain Free Sale - Ready To Move Into \* Situated in a Victorian villa built in 1885 and rich in local history, this newly refurbished three-bedroom, two-bathroom conversion features a spacious southeast-facing garden. It also offers an allocated parking space, low running costs, and a 999-year lease.

"Photography used from a previous development by the same developer also on the same road to display an indicative final finish"

Earlsfield is a charming and vibrant area located in the southwest London borough of Wandsworth. This residential neighbourhood exudes a unique blend of urban convenience and suburban tranquillity, making it a popular choice for families and young professionals alike.

### Features

Chain Free  
Ready To Move Into!  
Victorian Rebuild - 1885  
Victorian Period Conversion  
Allocated Parking Space  
Private Garden  
Three Bedrooms  
Two Bathrooms  
999 Year Lease

Earlsfield Road,  
Earlsfield, SW18

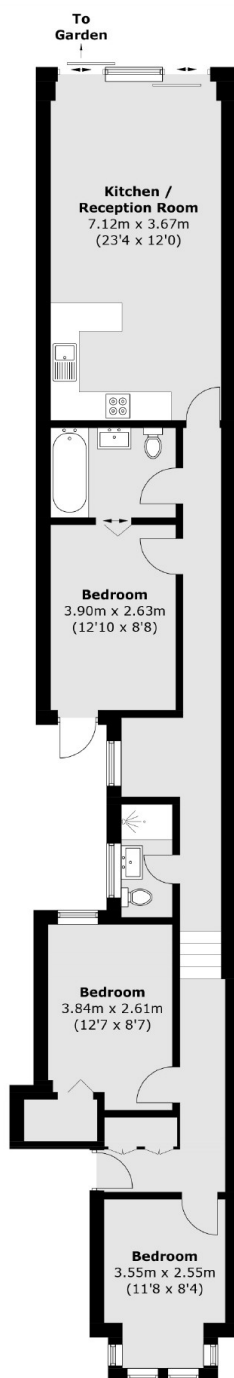

**Raised Ground Floor**

Total area (approx.): 87.6 sq. m (942.9 sq. ft)

**Dexters**

New Homes South London  
12 The Broadway  
London  
SW19 1RF  
Sales  
020 8674 4555

Energy Rating: . We aim to make our particulars both accurate and reliable. However they are not guaranteed; nor do they form part of an offer or contract. If you require clarification on any points then please contact us, especially if you're traveling some distance to view. Please note that appliances and heating systems have not been tested and therefore no warranties can be given as to their good working order.



[dexters.co.uk](http://dexters.co.uk)