

## Durnsford Road, SW19

### £410,000

A one double bedroom maisonette apartment with high ceilings and a great specification throughout, including underfloor heating and energy efficient appliances. The property benefits from a 999-year lease, a share of the freehold and no chain.

\* Please note - CGI imagery has been used to demonstrate the indicative final finish for the development \*

Wimbledon's unique blend of urban energy and suburban tranquillity provides an ideal setting for modern living. From artisan markets to scenic parks, the neighbourhood caters to a variety of lifestyles. Its excellent transport links ensure easy access to central London, making it a desirable location for those seeking both convenience and character.

### Features

- Chain Free
- Own Front Door
- Share Of The Freehold
- One Double Bedroom
- Underfloor Heating
- Energy Efficient Design
- No Ground Rent

# Durnsford Road, Wimbledon, SW19

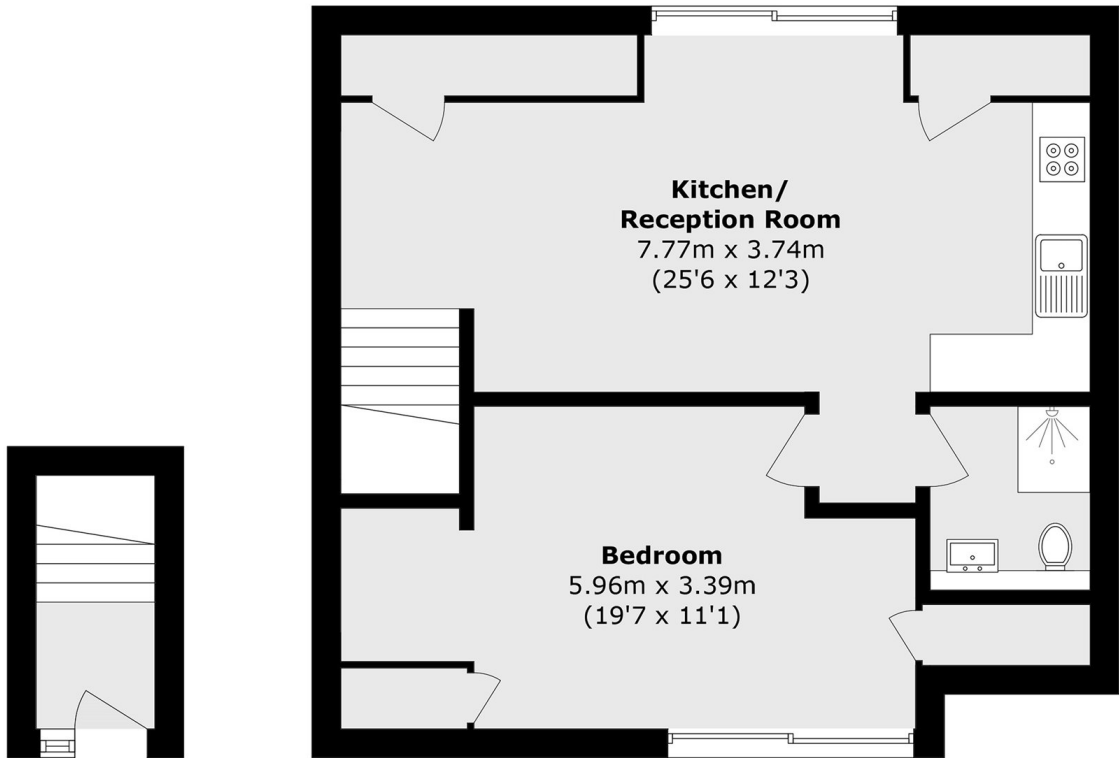

**Ground Floor**

**First Floor**

Total area (approx.): 58.0 sq. m (624.3 sq. ft)