



## Durnsford Road, SW19

### £590,000

A large two bedroom apartment arranged over one floor, with one bathrooms and a large balcony/roof terrace with views across the park. There is an allocated parking space, a high specification throughout, including underfloor heating.

\* Please note - CGI imagery has been used to demonstrate the indicative final finish for the development \*

Wimbledon's unique blend of urban energy and suburban tranquillity provides an ideal setting for modern living. From artisan markets to scenic parks, the neighbourhood caters to a variety of lifestyles. Its excellent transport links ensure easy access to central London, making it a desirable location for those seeking both convenience and character.

### Features

- Allocated Parking Space
- Two Double Bedrooms
- One Bathrooms
- Large Terrace/Balcony
- Share Of The Freehold
- Brand New Build

# Durnsford Road, Wimbledon, SW19

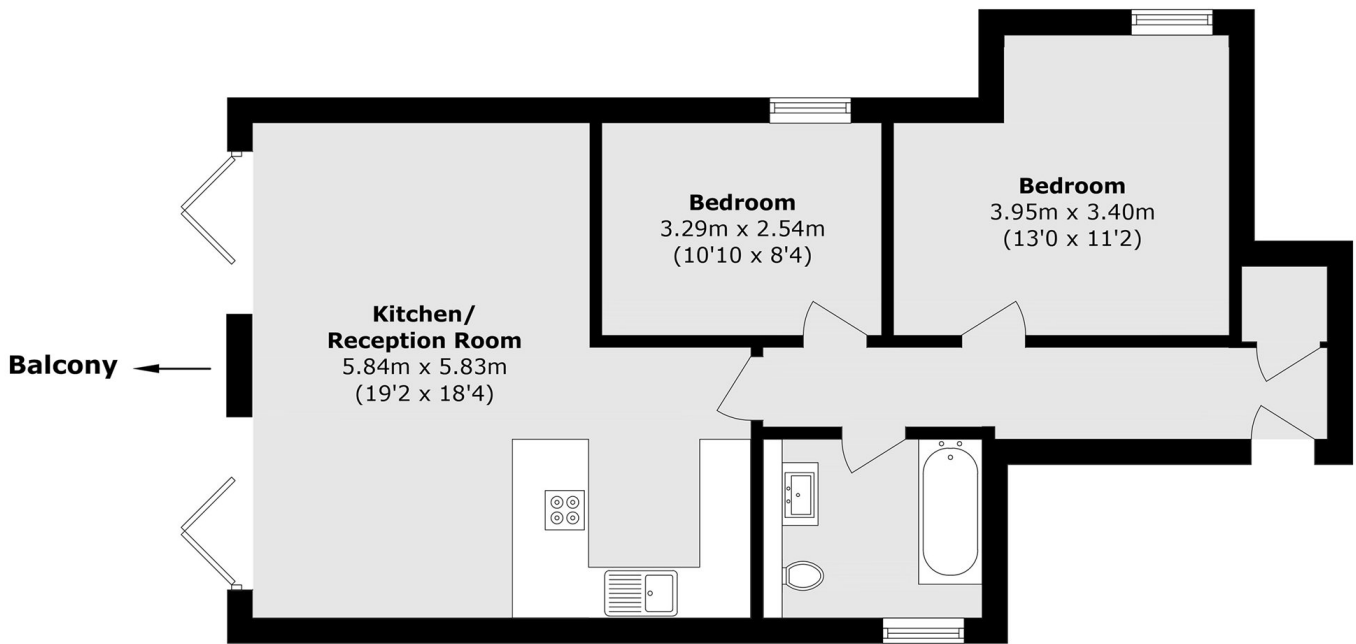

## First Floor

Total area (approx.): 66.2 sq. m (712.6 sq. ft)