



Lensbury Avenue, SW6
£750,000

Waterview

A beautifully presented, spacious two double bedroom apartment measuring 995 sq ft with private balcony overlooking landscaped communal gardens and The Thames in this exclusive riverside development.

Imperial Wharf is a prestigious riverside development with a selection of shops and restaurants with Imperial Wharf Station nearby.





Accommodation is made up of entrance hall leading to a spacious double reception room with dining area and doors to a private, river facing balcony. Off the living area there are doors to a stylish integrated kitchen. The large principal double bedroom has floor to ceiling windows, built-in wardrobes and en-suite shower room. There is a further generous double bedroom with access to balcony, built-in wardrobes and a family bathroom.

The apartment is presented in superb condition and offered with no onward chain. Located on the fifth floor with lift access, there is an excellent concierge service.

Features

- Beautiful Apartment
- Two Double Bedrooms
- Two Bathrooms
- Private Balcony
- Excellent Concierge
- No Chain



Lensbury Avenue, Fulham, SW6

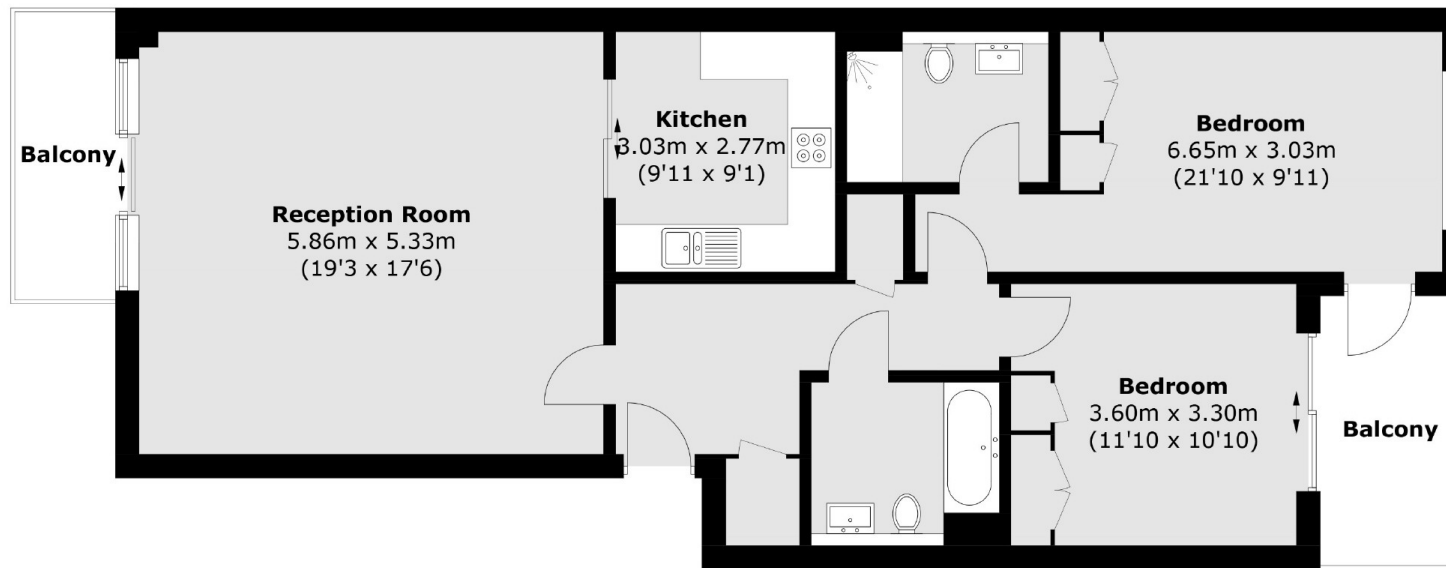

Fifth Floor

Total area (approx.): 92.4 sq. m (994.6 sq. ft)
Balcony: 10.7 sq. m (115.2 sq. ft)

Contact

To arrange a viewing call our office on the number below or visit our website.



Energy Rating: . We aim to make our particulars both accurate and reliable. However they are not guaranteed; nor do they form part of an offer or contract. If you require clarification on any points then please contact us, especially if you're traveling some distance to view. Please note that appliances and heating systems have not been tested and therefore no warranties can be given as to their good working order.

