

## Juniper Drive, SW18

£425,000

A contemporary one bedroom apartment, located within this prestigious riverside development. Offering spacious living space and a private balcony with views over the River Thames.

Battersea Reach is an award-winning riverside development, located moments from the transport links of Wandsworth Town & Clapham Junction. Residents benefit from 24-hour concierge & an exclusive gym.

### Features

- One Bedroom
- Private Balcony
- Parking Space
- Furnished
- 24hr Concierge
- Gym

## Juniper Drive, London, SW18

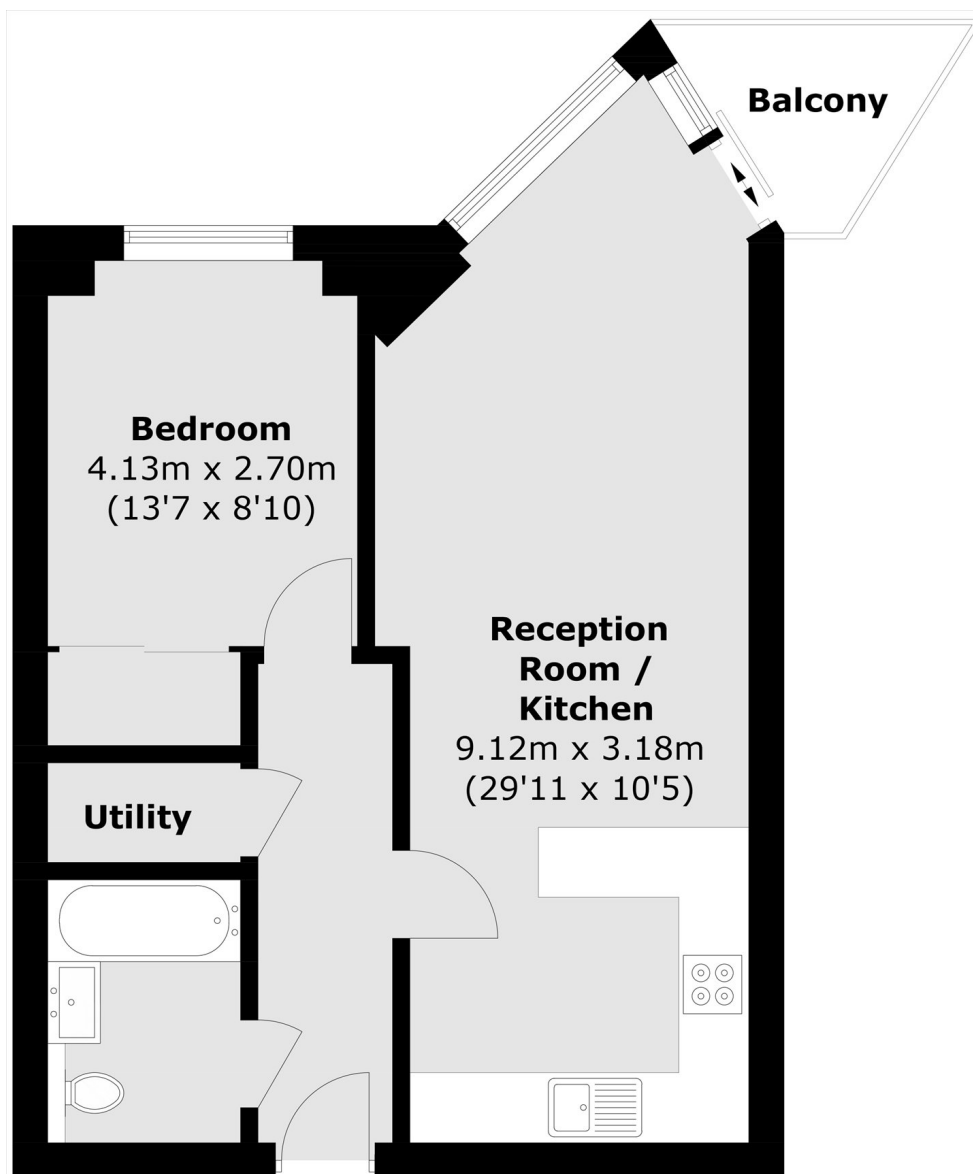

Total area (approx.): 47.4 sq. m (510.2 sq. ft)  
Balcony area : 2.9 sq. m (31.2 sq. ft)

### Contact

To arrange a viewing call our office on the number below or visit our website.



Energy Rating: B. We aim to make our particulars both accurate and reliable. However they are not guaranteed; nor do they form part of an offer or contract. If you require clarification on any points then please contact us, especially if you're traveling some distance to view. Please note that appliances and heating systems have not been tested and therefore no warranties can be given as to their good working order.