



Stapleton Hall Road, N4 £315,000

A well proportioned one bedroom apartment set within this Double Fronted Victorian house. This property has an open plan kitchen/ living room, a bathroom and lots of natural light and a share of the freehold.

Stapleton Hall Road is a fantastic location in Stroud Green with brilliant transport links, only minutes away from Finsbury Park Underground station, Crouch Hill and Harringay Green Lanes.

Features

- One Double Bedroom
- Open Plan Kitchen/Reception
- Share of Freehold
- Excellent Transport Links
- Natural Light
- Victorian Features

Stapleton Hall Road, London, N4

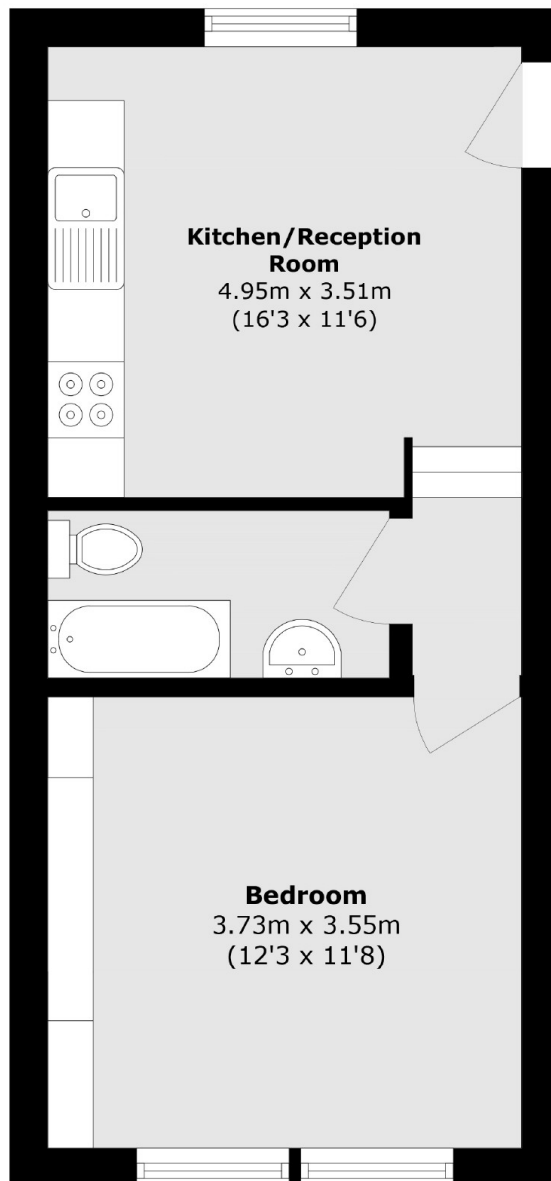

Total area (approx.): 32.3 sq. m (347.6 sq. ft)

Dexters

Finsbury Park
87 Stroud Green Road
Finsbury Park
London
Sales
020 7483 6360

Energy Rating: C. We aim to make our particulars both accurate and reliable. However they are not guaranteed; nor do they form part of an offer or contract. If you require clarification on any points then please contact us, especially if you're traveling some distance to view. Please note that appliances and heating systems have not been tested and therefore no warranties can be given as to their good working order.

 **RICS** | Regulated
Estate Agent
and Letting Agent

[dexters.co.uk](https://www.dexters.co.uk)