



## Pump House Crescent, TW8

**£611** Per week

A two bedroom apartment in the highly desirable Kew Bridge West development with an open plan reception, underground parking and an on-site concierge.

The Kew Bridge West development is well-located for access to Brentford High Street, Kew Bridge mainline station, Gunnersbury underground and the M4/A4.

### Features

- Two Bedrooms
- New-Build
- Open Plan
- On-Site Gymnasium
- Underground Parking
- Concierge Service

# Pump House Crescent, Brentford, TW8

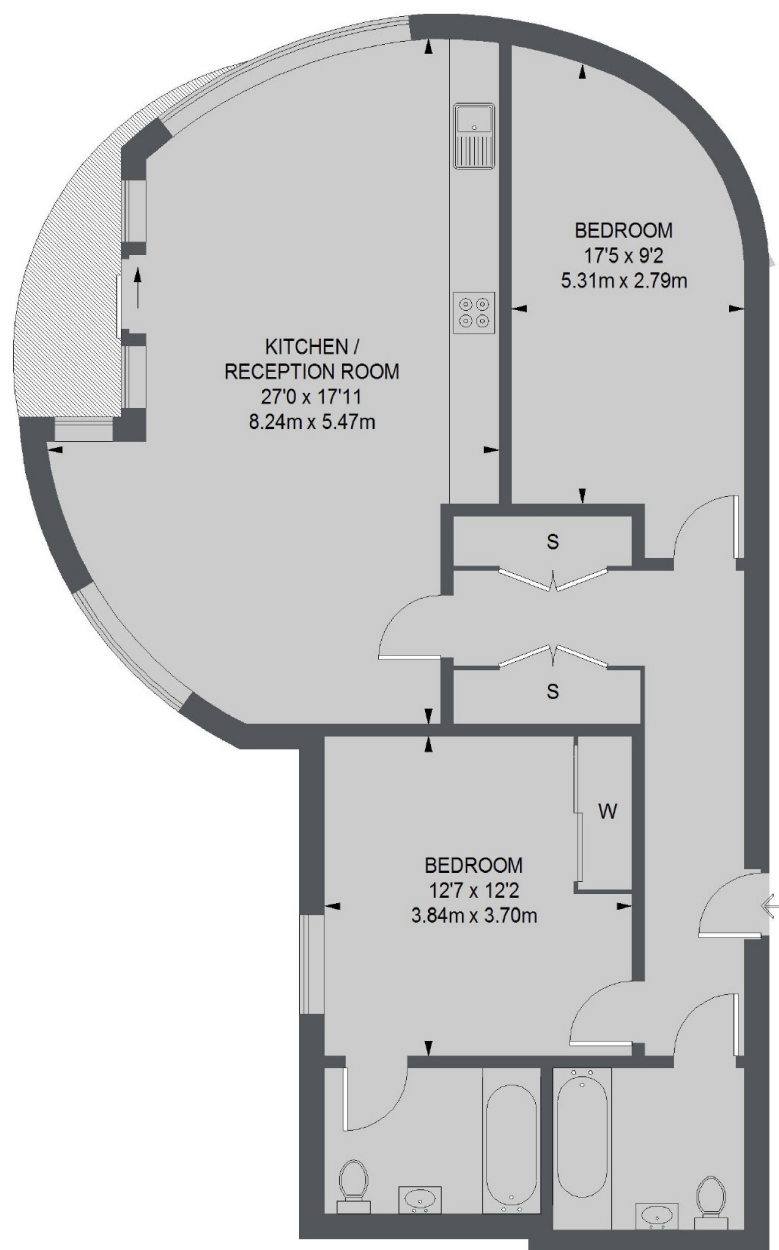

TOTAL APPROX. FLOOR AREA 944 SQ. FT. (87.70 SQ. M.)

## Dexters

Brentford  
194 High Street  
Brentford  
TW8 8LB  
Lettings  
020 8939 6077

Energy Rating: C. We aim to make our particulars both accurate and reliable. However they are not guaranteed; nor do they form part of an offer or contract. If you require clarification on any points then please contact us, especially if you're traveling some distance to view. Please note that appliances and heating systems have not been tested and therefore no warranties can be given as to their good working order.

 **RICS** | Regulated  
Estate Agent  
and Letting Agent

[dexters.co.uk](https://www.dexters.co.uk)