



Albany Road, TW8

£542 Per week

A two double bedroom recently redecorated period home located on this popular residential road. The property has a large reception room, a dining room, a modern kitchen and a private garden.

Albany Road is a popular road in Central Brentford and close to Brentford Mainline Station, the High Street and the River Thames. Also easy and excellent access to South Ealing and Kew Bridge Stations.

Features

- Two Double Bedrooms
- Reception Room
- Family Bathroom
- South Facing Patio/Garden
- Beautifully Presented
- Wood Floors
- Transport Links

Albany Road, Brentford, TW8

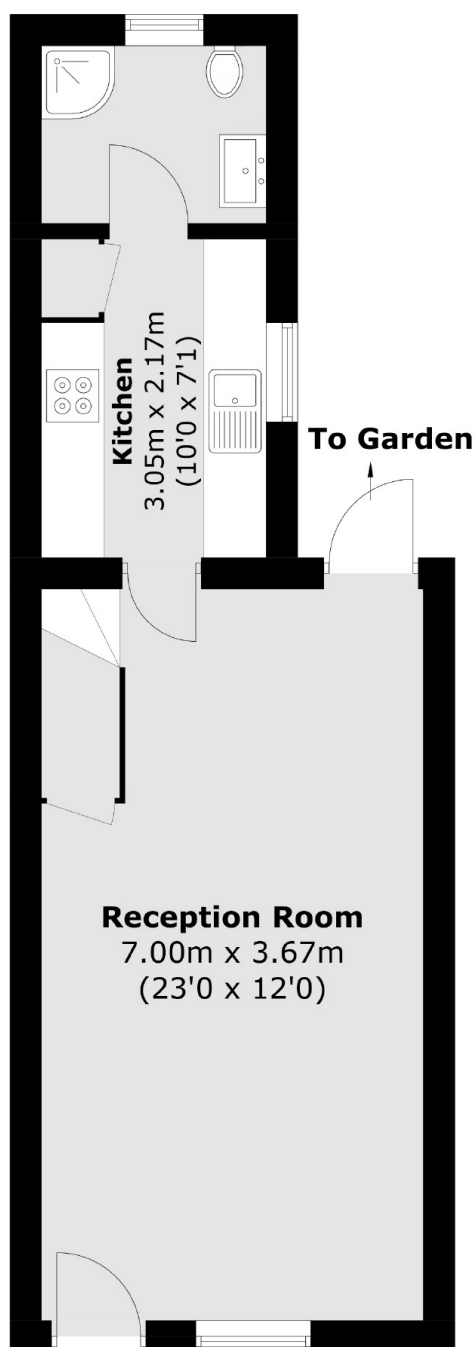

Ground Floor

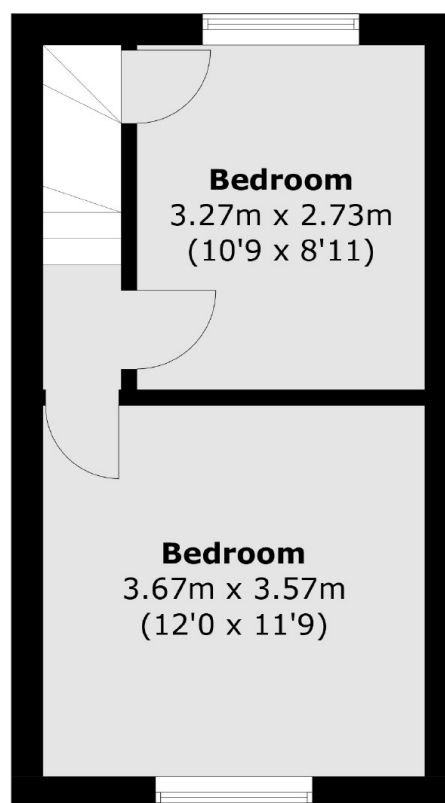

First Floor

Total area (approx.): 62.5 sq. m (672.8 sq. ft)