



Cutter Lane, SE10

£400,000

A luxurious one bedroom apartment in a sought after location with a private balcony with views over the O2 and river Thames. It offers contemporary finishes and wooden flooring, this apartment would make an ideal purchase.

Located a short walk from North Greenwich bus and tube station, adjacent to the IFS Cloud Cable Car and opposite North Greenwich Pier, transport links are readily available.

Features

One Bedroom
Forth Floor
Modern Apartment
No Work Required
Ideal First Purchase
Sought After Location

Cutter Lane,
London, SE10

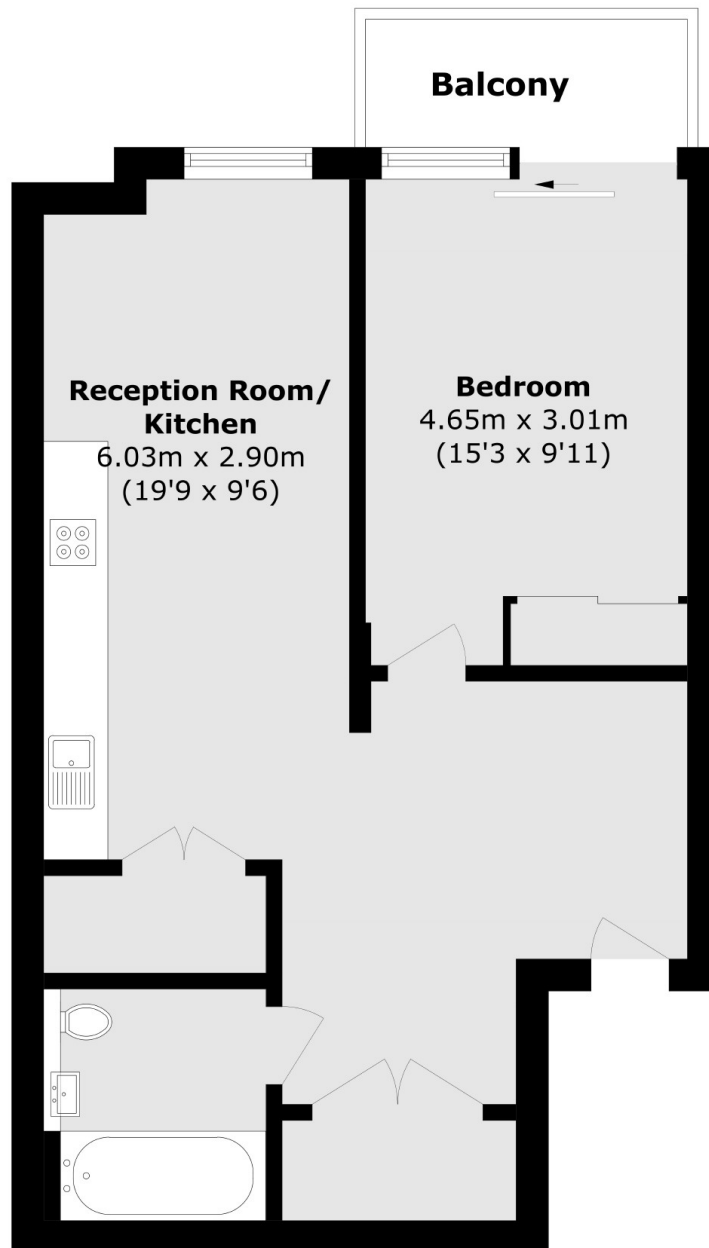

Total area (approx.): 54.4 sq. m (585.5 sq. ft)
Balcony area (approx.): 3.6 sq. m (38.7 sq. ft)