



Seafarer Way, SE16

£475,000

Located in this sought after development, this two double bedroom flat is in fantastic condition and offers two bathrooms, a large open plan kitchen living space, stunning views, private balcony, concierge and gym facilities.

Sirius House is located only 0.5 miles from Surrey Quays station and 0.8 miles from Canada Water station offering excellent transport links to all of London. A wide range of shops, cafés and restaurants are close by.

Features

- Two Double Bedrooms
- Two Bathrooms
- Excellent Condition
- Chain Free
- Concierge & Gym Facilities
- Stunning Views

Seafarer Way, London, SE16

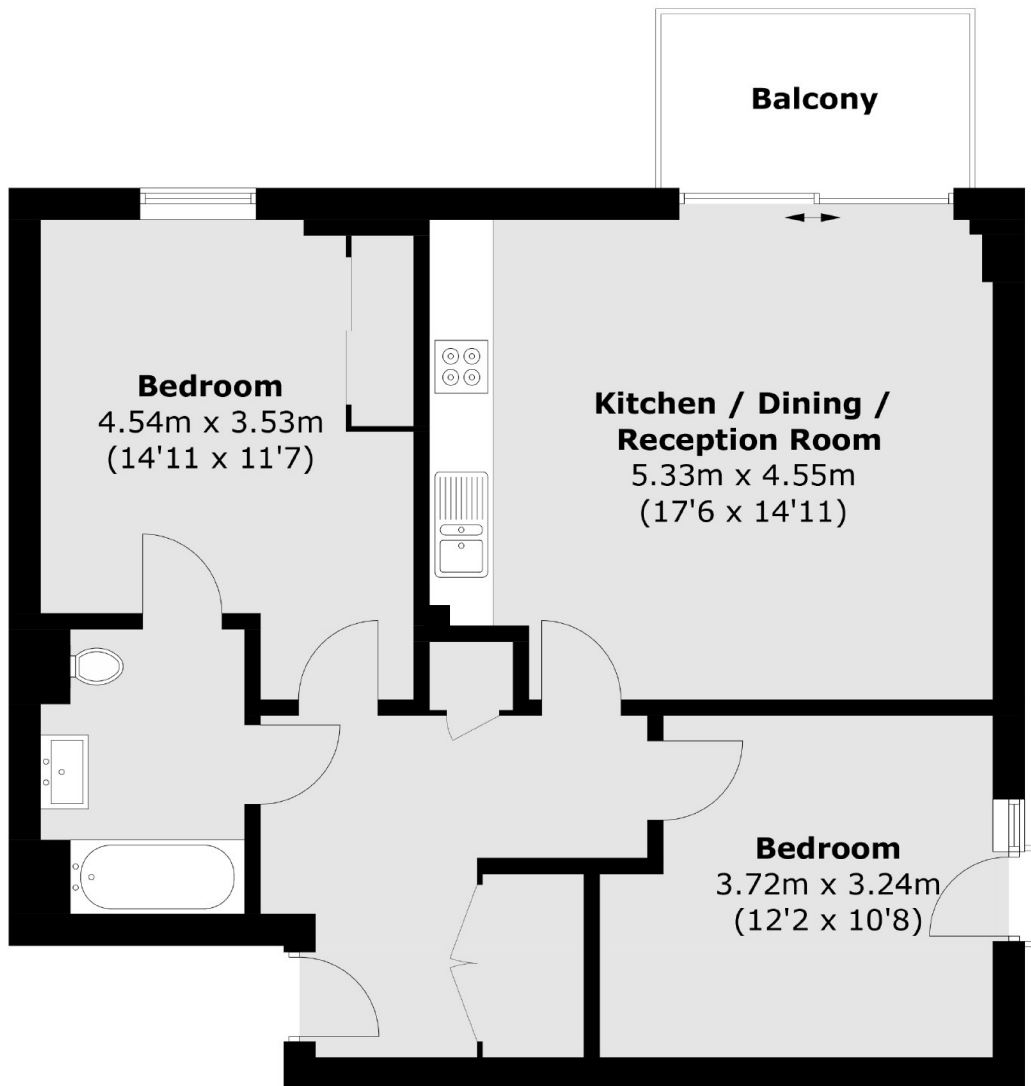

Total area (approx.): 68.6 sq. m (738.4 sq. ft)
Balcony area : 4.8 sq. m (51.7 sq. ft)

Dexters

Canada Water
Montreal House
Surrey Quays Road
London
Sales
020 7650 5144

Energy Rating: B. We aim to make our particulars both accurate and reliable. However they are not guaranteed; nor do they form part of an offer or contract. If you require clarification on any points then please contact us, especially if you're traveling some distance to view. Please note that appliances and heating systems have not been tested and therefore no warranties can be given as to their good working order.

 **RICS** | Regulated
Estate Agent
and Letting Agent

[dexters.co.uk](https://www.dexters.co.uk)