



Clarence Mews, SE16

£4,000 Per calendar month

This stunning four bedroom, four bathroom Georgian style end of terrace townhouse is situated within a secure gated development. Arranged over three floors, the property features a welcoming entrance hall, cloakroom, and a fully fitted kitchen with direct access to the garden and garage. The first floor has the reception room and a bedroom with ensuite, while the second floor offers a landing with storage and two further bedrooms, both being ensuite. The entire top floor is occupied by a bedroom with an ensuite.

Clarence Mews is a peaceful riverside enclave in Rotherhithe, close to green spaces and local amenities, with excellent transport links via Rotherhithe, Canada Water stations and the Canada Water Saturday Market.

Features

Four Bedrooms



Clarence Mews, SE16



Clarence Mews, London, SE16

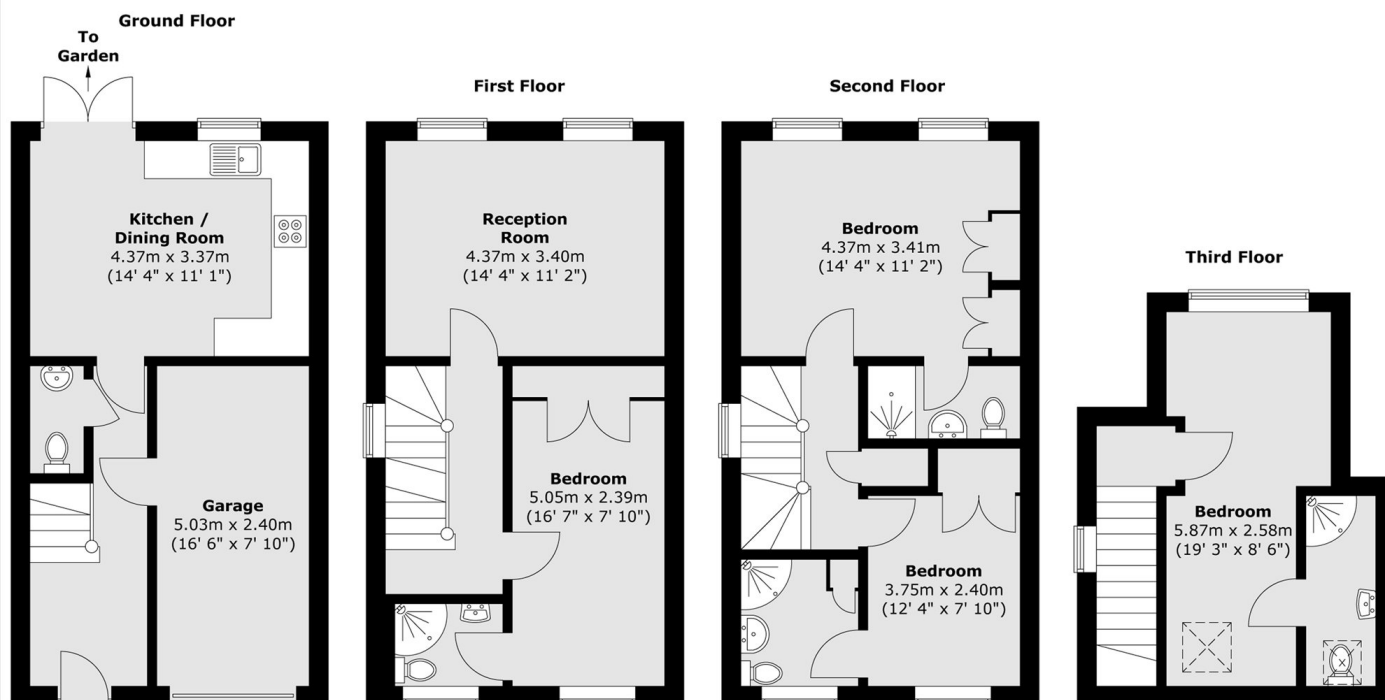

Total area (approx.) : 135.9 sq. m (1463 sq. ft)