



## Clarence Mews, SE16

£4,000 Per calendar month

This stunning four bedroom, four bathroom Georgian style end of terrace townhouse is situated within a secure gated development. Arranged over three floors, the property features a welcoming entrance hall, cloakroom, and a fully fitted kitchen with direct access to the garden and garage. The first floor has the reception room and a bedroom with ensuite, while the second floor offers a landing with storage and two further bedrooms, both being ensuite. The entire top floor is occupied by a bedroom with an ensuite.

Clarence Mews is a peaceful riverside enclave in Rotherhithe, close to green spaces and local amenities, with excellent transport links via Rotherhithe, Canada Water stations and the Canada Water Saturday Market.

### Features

Four Bedrooms

# Clarence Mews, London, SE16

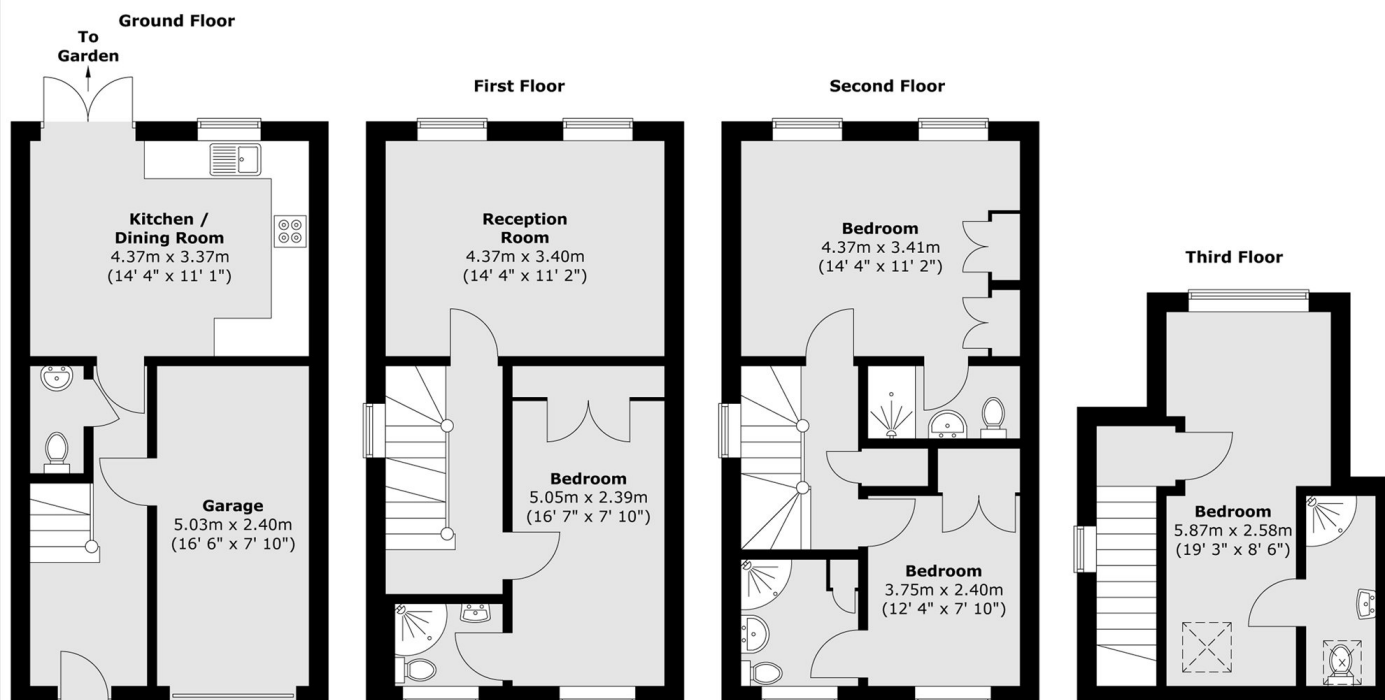

Total area (approx.) : 135.9 sq. m (1463 sq. ft)