



Rathbone Market, E16

£350,000

We are pleased to present this two-bedroom apartment within the highly sought-after Rathbone Market development. Offering 689 sq ft of internal living space, the property features an open-plan living and kitchen area, a private balcony accessed via the reception room, a secure entry phone system, and an abundance of natural light throughout. Residents also benefit from access to a private residents-only roof terrace.

Rathbone Market is conveniently located for access to the City and Canary Wharf, with Canning Town Station just 0.4 miles away. The development is also surrounded by a wide range of local amenities, including cafés, restaurants, and grocery stores.

Features

- Two Bedrooms
- Balcony
- Roof Terrace
- 689 Square Feet
- Open Plan
- Natural Light

Rathbone Market, London, E16

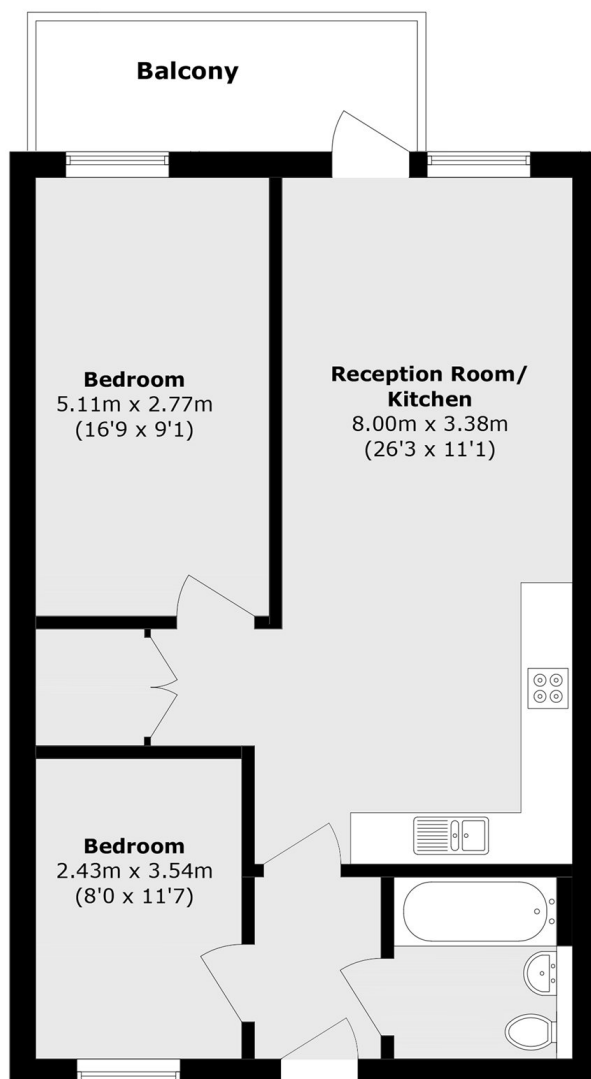

Total area (approx.): 64.1 sq. m (689.9 sq. ft)

Balcony area (approx.): 6.7 sq. m (72.1 sq. ft)