



# The Close

Weston Underwood, Buckinghamshire

oriordanbond



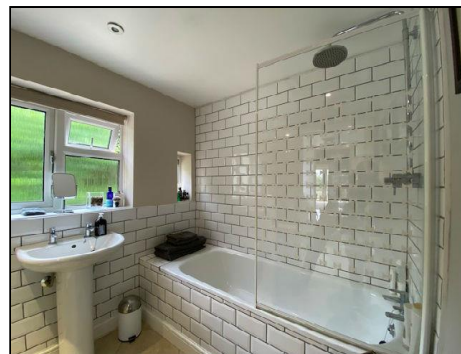

## The Close

Weston Underwood  
Buckinghamshire

PRICE £350,000

An outstanding village home set between the Church and open fields in one of Buckinghamshire's most famous and well regarded villages.

The accommodation comprises entrance hallway, sitting room, kitchen/dining room and a refurbished downstairs bathroom. To the first floor are three bedrooms with en-suite shower room to the master. There is a further first floor WC. The property benefits from independent gas central heating and double glazing throughout. Outside are rear gardens with adjacent off road parking, brick-store and patio area with lovely views to the church. To the rear is a south-westerly facing garden with views directly over open farmland. (B/924/M)

### Additional Information

- Milton Keynes Central: 9.8 Miles:
- Olney Market Place: 2.2 Miles
- Council Tax Band: C
- Energy Efficiency Rating: TBC

### Viewing

Viewing strictly by appointment – details below

### Disclaimer

O'Riordan Bond Estate Agents Limited has not tested apparatus, equipment, fittings or services and so cannot verify they are in working order. The buyer is advised to obtain verification from their solicitor or surveyor.

O'Riordan Bond Olney

01234 714003

olney@oriordanbond.co.uk

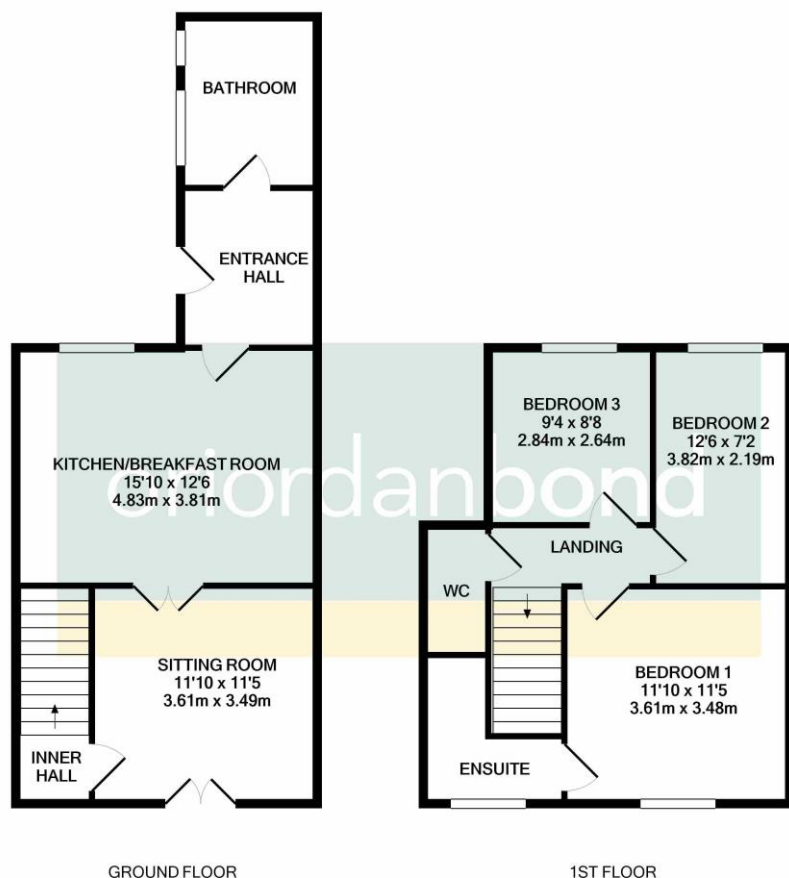

TOTAL APPROX. FLOOR AREA 924 SQ.FT. (85.8 SQ.M.)

Whilst every attempt has been made to ensure the accuracy of the floor plan contained here, measurements of doors, windows, rooms and any other items are approximate and no responsibility is taken for any error, omission, or mis-statement. This plan is for illustrative purposes only and should be used as such by any prospective purchaser. The services, systems and appliances shown have not been tested and no guarantee as to their operability or efficiency can be given  
Made with Metropix ©2020