

T: 01333 310481

E: [anstruther@thorntons-law.co.uk](mailto:anstruther@thorntons-law.co.uk)  
[www.thorntons-property.co.uk](http://www.thorntons-property.co.uk)

Dundee | Anstruther | Arbroath | Cupar | Edinburgh  
Forfar | Kirkcaldy | Montrose | Perth | St Andrews

**Thorntons**   
*Let's get a move on!*



**6 Rolland Street**  
| St Monans | KY10 2BH

Offers Over £99,000

Living Room	16'5 x 12'0	5.00m x 3.66m
Kitchen	12'0 x 7'6	3.66m x 2.29m
Bedroom 1	16'4 x 10'5	4.98m x 3.18m
Bedroom 2	11'6 x 10'4	3.51m x 3.15m
Bath	6'5 x 5'4	1.96m x 1.63m
Wc	3'9 x 2'6	1.14m x 0.76m



Pleasantly located semi-detached home with drive to front and south facing garden. The front and back door were recently replaced. The gravel drive allows off-street parking for at least two cars. The hall has an under stair cupboard and useful ground floor WC. The dual aspect living room is a light bright room. The kitchen has a rear vestibule with door to the garden. The first floor has the main bedroom which is dual aspect, benefitting from a fitted cupboard and enjoys a lovely view over the roof tops toward the Forth and historic church spire. The second bedroom has a fitted wardrobe. The family bath room completes the accommodation. The property benefits from double glazing and gas central heating. The rear garden is laid for ease of maintenance with patio extending from the house, gravel and timber shed which is to be included in the sale price.



- Partial Sea Views
- Semi Detached Home
- Living Room
- Kitchen
- Two Bedrooms
- Bathroom & WC
- GCH, DG, EPC D
- Back Garden & Front Drive

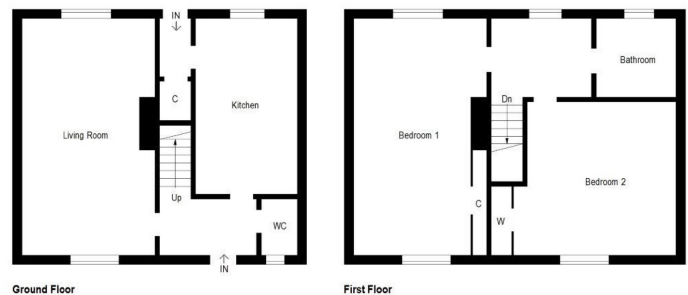

Illustration For Identification Purposes Only. Not To Scale (ID480595 / Ref 67529)

Thorntons is a trading name of Thorntons LLP. Note: While Thorntons make every effort to ensure that all particulars are correct, no guarantee is given and any potential purchasers should satisfy themselves as to the accuracy of all information. Floor plans or maps reproduced within this schedule are not to scale, and are designed to be indicative only of the layout and location of the property advertised.

aspc êspc fifêspc p̂spc t̂spc ŝpc



**Thorntons**  
Let's get a move on!

T: 01333 310481

E: [anstruther@thorntons-law.co.uk](mailto:anstruther@thorntons-law.co.uk) [www.thorntons-property.co.uk](http://www.thorntons-property.co.uk)

Dundee | Anstruther | Arbroath | Cupar | Edinburgh | Forfar | Kirkcaldy | Montrose | Perth | St Andrews