



PUTTERILLS

est. 1992

3 Chancery Place, Old Park Road, Hitchin, SG5 2ED
Guide price £230,000

A nearly new and beautifully presented two bedroom ground floor apartment superbly located close to the town centre.

Built to a high specification in 2018 this two bedroom ground floor apartment is ideally located for those who need to access town centre amenities. The accommodation includes an entrance hall, kitchen/living area, two double bedrooms, modern bathroom and allocated parking.

Hitchin is on the London Kings Cross east coast mainline and the fastest service to London Kings Cross takes just 28 minutes, to Cambridge takes 33 minutes and Peterborough, 38 minutes. Hitchin often features as one of the best places to live in the UK and offers a wide selection of excellent shops, schools, pubs, restaurants, leisure facilities and places of worship.

ACCOMMODATION

ENTRANCE HALL

KITCHEN/LIVING ROOM 14' x

BEDROOM ONE 11'6" x 9'9"

BEDROOM TWO 11'10" X 7'2"

BATHROOM 7' x 5'9" max

EXTERNALLY

ALLOCATED PARKING

TENURE

We are advised by our client that this property is:

Leasehold

Term remaining: 125 years from 2018

Ground Rent: £300 per annum

Service Charge: £125 per month

This information should be

clarified by your legal representative.

EPC

EER: C

FLOORPLAN AND

All measurements are approximate and for general guidance only and whilst every attempt has been made to ensure accuracy, they must not be relied on or form any part of a legal contract. The fixtures, fittings and appliances referred to have not been tested and therefore no guarantee can be given and that they are in working order. Internal photographs are reproduced for general information and it must

not be inferred that any item shown is included with the property.

VIEWING INFORMATION

By appointment only through Putterills of Hertfordshire, through whom all negotiations should be conducted.

MONEY LAUNDERING

Prior to a sale being agreed, prospective purchasers will be required to produce identification documents. Your co-operation with this, in order to comply with Money Laundering regulations, will be appreciated and assist with the smooth progression of the sale.





Ground Floor

Approx. 43.2 sq. metres (464.7 sq. feet)

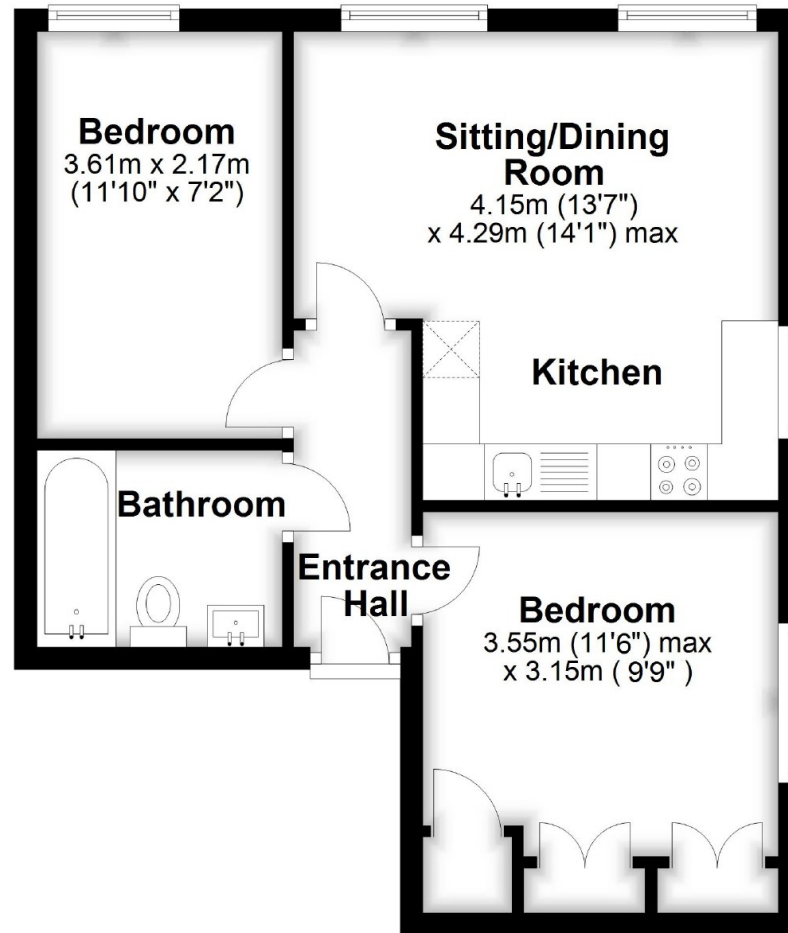

Total area: approx. 43.2 sq. metres (464.7 sq. feet)



PUTTERILLS

est. 1992

putterills.co.uk | 01462 632222 | hitchin@putterills.co.uk

You may download, store and use the material for your own personal use and research. You may not republish, retransmit, redistribute or otherwise make the material available to any party or make the same available on any website, online service or bulletin board of your own or of any other party or make the same available in hard copy or in any other media without the website owner's express prior written consent. The website owner's copyright must remain on all reproductions of material taken from this website.