



A one bedroom McCarthy & Stone retirement apartment within the heart of Knebworth village

A spacious 1 bedroom second floor RETIREMENT APARTMENT with generous lounge/ dining room, contemporary well equipped kitchen, double bedroom, spacious walk-in wardrobe and a modern wet room. Decorated in neutral tones and benefitting from features including Oak veneer doors, under-floor heating and double glazing. EER: B. CHAIN FREE. Agent's Note: whilst we await access for photography, the images used in these particulars are archive photographs from 2019.

Constance Place is a highly exclusive McCarthy & Stone built development of just 26 individual & well planned apartments specifically designed to offer the very best in retirement living for the 60+ age group. Set within gorgeous landscaped gardens and within easy reach of the local village amenities and mainline rail link, these beautiful properties offer an elegant ancillary club lounge, GUEST SUITE FOR VISITORS, a house manager, video entry system and 24 hour emergency call links from your apartment. These fine homes offer an excellent option for those down-sizing and seeking security and comfort.

Knebworth village lies between the towns of Stevenage (to the north) and Welwyn G City (to the south). The County Town of Hertford is within a short driving distance and London is easily accessible by road via the A1(M), or the mainline rail link (Kings Cross approx 32 minutes).

Our busy High Street has shops that adequately cater for daily needs and includes: chemist, post office, library, doctors surgery, 2 dentists, Cooperative general store, well regarded junior/mixed infant school (so there is lots of young life in the village), churches and a recreational ground with tennis courts, bowling green and children's play area for visiting family. On the village outskirts is Knebworth private members Golf Club and a Fitness centre with pool facilities.





Constance Place - Communal Area



Second Floor

Approx. 55.1 sq. metres (592.7 sq. feet)

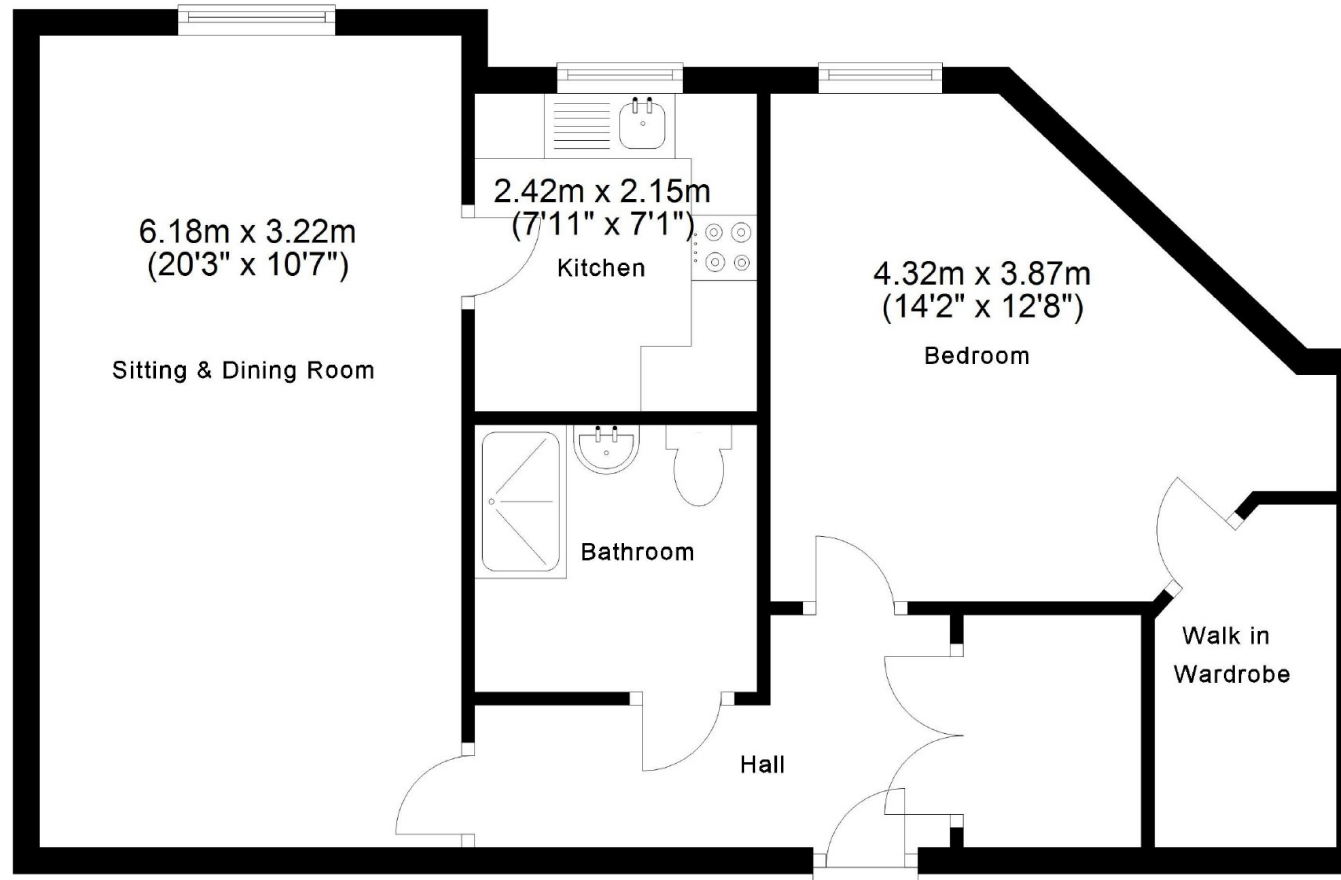

Total area: approx. 55.1 sq. metres (592.7 sq. feet)



PUTTERILLS

est. 1992

putterills.co.uk | 01438 817007 | kneb@putterills.co.uk

All measurements are approximate and for general guidance only and whilst every attempt has been made to ensure accuracy, they must not be relied on or form any part of a legal contract. The fixtures, fittings and appliances referred to have not been tested and therefore no guarantee can be given and that they are in working order. Internal photographs are reproduced for general information and it must not be inferred that any item shown is included with the property. Prior to a sale being agreed, prospective purchasers will be required to produce identification documents. Your co-operation with this, in order to comply with Money Laundering regulations, will be appreciated and assist with the smooth progression of the sale.