



**136, Oxford**

**£1,375 PCM**

CUMNOR HILL  
Botley c 1.5 miles, Oxford c 3.5 Miles, M40 J9 c 7.5 Miles

A stylish development at the top of Cumner Hill that was completed in 2016. WEST - The Property Consultancy are pleased to offer a stunning 700 sq ft, two bed, furnished apartment in this striking building of just nine apartments. Offering a fully equipped kitchen with breakfast bar, fridge freezer, oven, hob, dishwasher and washer dryer. 17ft x 18 ft Kitchen / Living room with patio doors leading to private patio and communal garden, two double bedrooms both with wardrobes and ample storage, Kahrs engineered wood floor and underfloor heating throughout, Custom veneered doors, Fully tiled bathroom with external window and allocated parking for 2 cars.



- 2 Double Bedrooms
- Bathroom
- Fully Equipped Kitchen
- Under Floor Heating
- 2 Parking Spaces
- Furnished

Contact: [gareth@west-tpc.co.uk](mailto:gareth@west-tpc.co.uk)  
(t) 01865 510000 (e) [gareth@west-tpc.co.uk](mailto:gareth@west-tpc.co.uk)

Administration fees will apply when making an application to secure a tenancy through WEST - The Property Consultancy. Please note that these figures are excluded from rental figures advertised here.

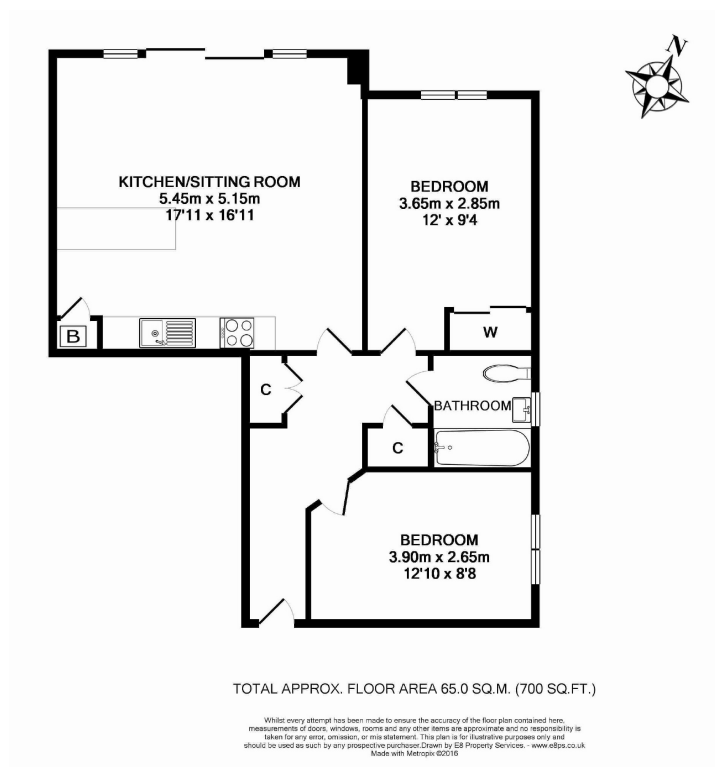

Take the Botley interchange on the A34 and proceed down the short stretch of dual carriageway to the traffic lights. Turn right and proceed up Cumnor Hill and about 1.0 Mile up the hill you will see the development on your right hand side.

You may download, store and use the material for your own personal use and research. You may not republish, retransmit, redistribute or otherwise make the material available to any party or make the same available on any website, online service or bulletin board of your own or of any other party or make the same available in hard copy or in any other media without the website owner's express prior written consent. The website owner's copyright must remain on all reproductions of material taken from this website.