

Whilst every attempt has been made to ensure the accuracy of this floor plan, measurements of doors, windows, rooms and sq. footage are approximate within 5% accuracy. For identification purposes only. Walls with small angles drawn straight. Not to be used as part of the decision to buy. You must rectify all details before purchase when you have confirmed them. Price on application for a 90 day licence to use this plan. No appliances tested. Not to scale. © www.steele.london - Email: patriciaa@steele.london - Tel: 07847 219401

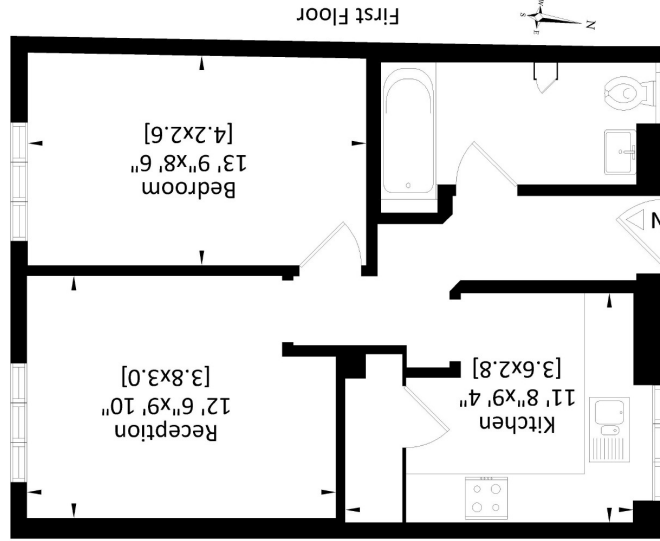

Islington
PROPERTIES LTD

Angel House N1
Gross Internal Area:
44 Sq. metres
470 Sq. feet

Pentonville Road, Angel



Pentonville Road, Angel

An attractive one bedroom flat located just moments' walk from Angel tube station and within walking distance of the City, Holborn and West End.

£360 Per week

