



SIGNATURE

by Mark Small

NORTH EAST



P Permit
holders
only
11M/2
Past This Point
Sat. Sun and
bank holidays

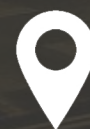

HOTSPUR STREET,
TYNEMOUTH, NE30 4EJ

Hotspur Street, Tynemouth, NE30 4EJ

A fantastic opportunity has arisen to the market to acquire this beautifully presented, two bedroom flat, idyllically positioned within the affluent and highly sought after area of Tynemouth. The property boasts attractive, contemporary design and decor throughout and presents an ideal chance to own a wonderful property in this picturesque coastal town.

The property begins with direct access into the spacious living room, offering a stunning feature fireplace and large windows which supply the room with envious amounts of natural light. From the living room there is access into both double bedrooms and the attractive kitchen. The kitchen benefits from neutral fitted storage space and a range of integrated appliances. From the kitchen there is a second reception hall with access to fitted storage space and the modern three piece shower room.

Externally, there is on street parking to the front with an alley adjacent to the home with additional off street parking. To the rear there is a low maintenance courtyard with a shed and high walls for additional privacy.

Tynemouth is one of the most prestigious and highly desirable areas in the North East with outstanding schooling and historic charm. Located less than ten minutes' walk away from the beach, the property also excellent road and rail links to the centre of Newcastle, as well as an elite selection of shops and restaurants.

Asking price £180,000



Property Floorplan

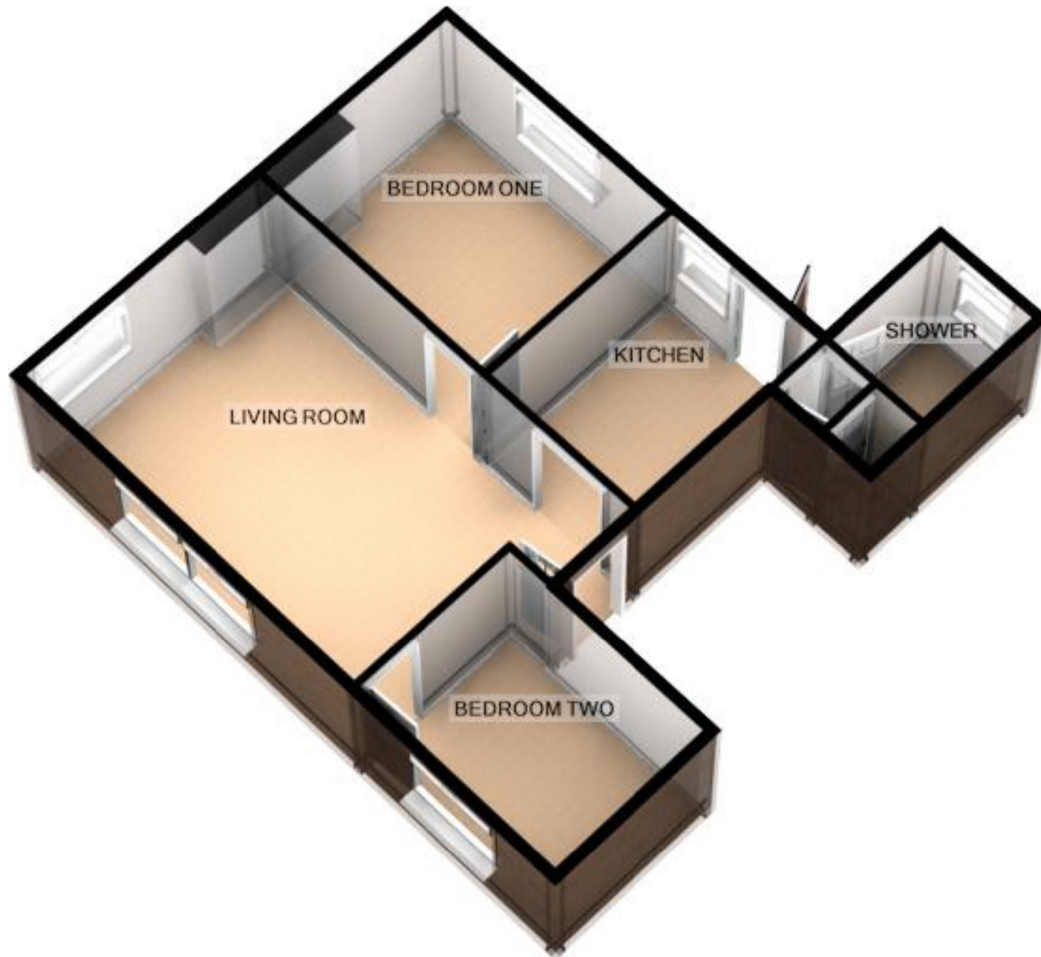

Measurements:

LIVING ROOM 20'3 X 12'4

KITCHEN 10'2 X 5'11

BEDROOM ONE 12'4 X 10'0

BEDROOM TWO 10'4 X 8'0

SHOWER ROOM 6'4 X 5'1

EPC Rating E

HOTSPUR STREET, TYNEMOUTH

For illustrative purposes only. Decorative finishes, fixtures, fittings and furnishings do not represent the current state of the property. Measurements are approximate. Not to scale
Made with Metropix ©2018



NO.1 AGENT IN THE NORTH EAST



"From organizing our first viewing to handing over the keys, we found the staff at Signature very professional and helpful. Finding a new home can be a stressful experience but we felt the service at Signature was smooth and hassle free." - Michelle

"I recently let my property through Signature. Every member of the team that I dealt with were friendly, professional and efficient." - Barry

TOP RATED ON ALLAGENTS.CO.UK

THE LARGEST NORTH EAST HYBRID ESTATE AGENCY WITH HIGH END BRANCHES

OUR LOCATIONS

Whitley Bay - 0191 251 3344
Tynemouth - 0191 296 6689
Whickham - 0191 432 5102
Jesmond - 0191 281 1037
Newcastle - 0191 640 2284
Ponteland - 01661 820 082

Gosforth - 0191 640 3523
Wallsend - 0191 432 4151
Heaton - 0191 432 4275
Cramlington - 01670 897 213
Morpeth - 01670 897 155
Forest Hall - 0191 2669 966

Gateshead - 0191 432 4294
Killingworth - 0191 640 3602
Durham - 0191 303 8252
Sunderland - 0191 543 6390
Alnwick - 01665 511 800
Ryton - 0191 4139 845